

on land her father had bought in 1838. She had hardly settled here when her house was filled with school children and her work of doing good went on. She sold her property here in 1865 moved to Rock Island County. Her mother was living with her when she died in 1872 aged 87 yrs. 11 mo. 19 days. In 1877 she moved to Elk Falls, Elk County, Kansas. In 1876 her brother came to live with her and died in 1880, aged eighty. She died there in January, 1890 at age 86. When she died she was drawing a pension of \$400 a month from the State of Conn. Granted for the wrong committed against her by the State in 1833.

PARDON CRANDALL a New England man of anti-slavery connections with other pioneers in the war against slavery. He visited Troy Grove Township in 1838, having bought 600 acres on section 1, 2, 11 and 12. Shortly after coming here he became sick with fever and ague. He returned home Hopkinton, R.I. where he died July, 1838. The title of the land passed to his widow Esther Carpenter Crandall. In 1841 his oldest son Hezekiah came west. He brought a breaking team and started turning over the soil. After staying two months he returned to his manufacturing interest. In Aug 1842, Mrs. Prudence Crandall Philleo accompanied by Obadiah Crandall her nephew, then 13 years old. In 1845 her mother Esther Crandall came to live with her. When Obadiah became of age he was given a share of the property, his grandmother deeded to him 380 acres for himself and brother Reuben, who had came in 1848. Ruben later married Amanda Smith. He improved his land and died there in 1864, he left his widow and two children. Esther and Clarissa Crandall came west with their grandmother in 1844. Esther married Joseph F. Worsley and Clarissa married Henry Keith moved to Kansas. Another granddaughter Hulda came later and married George Webber of Ophir Twp. Besides the sons and daughters already mentioned of Hezekiah two sons were born by his second marriage Hezekiah Jr. who went to Walla Walla, Washington to live and George who went to Iowa.

OBADIAH B. CRANDALL son of Hezekiah Crandall and Clarissa Cornel was born in Canterbury, Conn., April 4, 1829. In 1842 he came with his aunt, Prudence Crandall Philleo, to help take care of his grandfathers land. After his grandmother had given him land she came to live with him as a housekeeper until he married. Feb. 1856 he married Myra Bowers daughter of Henry and Myra. She was born in Niagara County, N.Y., July 23, 1832. Her father died March 5, 1861 and her mother July 5, 1865. They had four children John R. [1886 in Kansas] Jessie M. in Florida, Mark C. of Troy Grove Twp. and Jane died 16 months old. The farm is located just south of Crandall cemetery. Obadiah and Myra donated the land for the cemetery. Their descendents still live on the land. Mr. Crandall was a radical abolitionist, in the days of slavery.

[source in La Salle County History 1886]

Continued from page 23

Edward Balcom	Jacob Phillips	Samuel Reid
George Kidd	Jacob Phillips	E. W. Dewey
A. L. Gilbert*	Spencer Moffatt	David Moffatt
	James Fisher	

Out of the above named 104 volunteers 21 died in the service or in battle. Since the war 15 have died. The town can be proud of its record. What town of its population has done any better? Those who died in the service are marked with an *. [pl col 2 Reporter June 16 1896]

TROY GROVE TOWNSHIP - 1877

JL
LaSalle
1.6

ABRAMS J.D. clerk Troy Grove;
ACHART H. farmer sec. 16;
ACHART WM. rents farm
ADAMS J. farmer sec. 1;
AMPHER P. rents farm;
ANDREWS G.W. farm sec. 27;
ANDREWS O.A. farm sec. 27;

BAKER PETER farmer sec. 31;
BANKES J. laborer
BANKES JNO. laborer
BARTO ISSAC farm sec 2; born Lebanon Co., PA, Feb. 27, 1825, came to county in 1847; married Rebecca Miller of Lebanon County, PA, March 1850; four children William, Louise, Sarah; lost one daughter Adaline.;
BIERWORTH H. stone mason.
BLAIN JOHN laborer
BLANCHARD GEORGE L. farmer sec. 7; born in Essex Co. VT. Feb. 27, 1827; lived there 10 years; moved to Cleveland, Ohio, lived there 17 years; came to Co in 1855; engaged in Drug and Grocery business in Mendota; owns farm; married Susan E. Douglass of Ohio in 1848 she died in 1856; 2 children one lost; married Matilda Moore of Mendota in 1858; she died 1864; two children; married Caroline E. Tower in 1866; six children, lost two;
BOREMAN FRED farmer sec. 30;
BOWERS JACOB laborer;
BOWERS JOHN stone mason;
BOWERS THOS. laborer;
BRIGGS BENARON farmer sec. 1; born in Conn. Jan. 18, 1819; came to county in 1840; married Adelia Goddard from Hartford Co., Conn., Jan. 16, 1848; she was born July 30, 1830; came 1837, three children; Mrs. Ellen M. Wesley born Oct. 15, 1853; Dwight G. Aug. 1, 1853, Marcia E. Dec. 18, 1866;
BROMERSHAUKEL VICTOR farmer sec. 9;
BROWN FRANK farmer;

BROWN WM. farmer sec. 22; born Westmoreland Co., PA, May 31, 1825; came to Co. in 1850; married Pennelia F. Dash from Lebanon Co., PA, Nov. 16, 1852; she died Aug. 9, 1867; four children John Franklin, Mary, William E and Charles G. lost one son; married Mrs. Lydia Lupton of Ohio, May 31, 1870.
CASTLES ALFRED farmer;
CASHNER GEORGE farmer sec. 13; born Lycoming Co., PA, Dec. 25, 1835 came to Bureau Co. in 1857, came to this Co. in 1871; married Mary Palmer of PA, 1861; she died Jan. 12, 1870; one child Annie born Sept., 1868.
CARY GEORGE WASHINGTON farmer, born in June 4, 1832, first white male child born in County; oldest settler in Twp.; mother died in 1864, his father in 1867; married Fannie Hess of PA, she died 1857; then married Elizabeth Kohr of PA; March 28, 1861 have two children Charles Washington and Addie Cora.
CASTLES HUGH SCOTT farmer sec. 28; born in northern Ireland Feb 11, 1812; came to Canada 1832, came to U.S.A. to this county 1853; married Sarah Ann Morris of Somersetshire in April 1838; she died Oct. 1867; ten children, six boys, four girls; one son William killed in army at Fort Donelson
CHASE S.S. harness maker;
CLARK HENRY farmer sec. 4; Born in northern Ireland Aug 25, 1798; came to America 1826 lived in N.Y. where he was a merchant for 15 years; came here 1852; married Maria Hall of Granark, Ireland; four children James, John T, Catherine, Maria
CLARK JAS. farmer;
CLARK J.T. farmer;
CLARK SIMPSON farmer sec. 12; born in Grafton Co., N.H. March 12, 1806; lived in Boston 14 Yrs. Was on

TROY GROVE TOWNSHIP – 1877

police force, father fought in Revolution, his mother received a pension. Came to Co. in 1852. married Matilda E. Vickery 1829; she was born N.H.; two children Mrs. Chestina E. Chick and Mrs.

Matilda L. Johnston;

COLEMAN P. farm sec. 32;

COMBS BENJ. Rents farm;

CONLEY DAN laborer;

CONNOLY JNO. laborer;

CONNOLY R. SR. laborer;

CONNOLY R. JR. laborer;

COSS JAS. farmer sec. 15;

COSS JNO. farm sec. 15;

CRANDALL O.B. farm sec. 2;

CROISANT HENRY farmer;

CROISANT J. SR. farmer sec. 29;

CROISANT J. JR. farmer;

CROISANT WM. farmer;

DENER L. farmer sec. 21;

DEUTSCH JACOB wagon maker, Troy Grove;

DEVERAUX WM. laborer;

DEWEY PLINY farmer sec. 13; born in Broome Co., N.Y. Sept 10, 1811, when 10 moved to Ohio; came to this Co. 1832. married Lena Gillett of Conn. Jan. 1, 1840; children are; Hiller A. died in army, Joseph F., Delius H., Elizabeth R., Theodore A. [died].;

DORFNER JOHN salon keeper, Troy Grove;

EDINGER H. plasterer, Troy Grove;

EDWARDS WM. farmer sec. 35; born in Cambridgeshire, Eng. Nov. 6, 1832; came to U.S., State and Co. in 1853; was in army, Co. C, 104th I.V.I.; was musician in Regimental Cornet Band; married Snelling of Cambridgeshire, Eng. Aug. 8, 1853; three children; Mrs. Elizabeth Stotler, William R., and Frank S.; lost one;

EICH ADOLPH farmer;

EICH M. farmer sec. 16;

ENGLES JNO. farmer sec. 9;

ENGLES JOS. farmer sec. 9;

ENGLESKERCHEN HENRY farmer sec. 5; born in Germany Feb. 2, 1820; came to U.S. and Co. in 1848, lived in Peru two years; married Sebilla Beittgon in fall 1859, she was born in Germany; two children; Henry, Mary Helen; lost one Kathrina;

ENTZMINGER GEO. Farmer sec. 32;

EVERETT DR. M.L. physician; Troy Grove;

FAHLER DANIEL farmer sec. 10;

FAHLER J. farmer sec. 14;

FAYLER LEVI farmer sec. 15; born in Lebanon Co. PA, Aug. 12, 1842; came to this State & Co. 1849; married Catherine Gophart, Dec. 25, 1863; she was also born in Lebanon Co., PA.; two children William Edgar and Martin Frank.

FAHLER MOSES farmer sec. 22; born in Troy Grove Jan. 26, 1853; rents farm from his father; married Frances M. Dowling Jan. 29, 1875; one child Charlie born Oct. 29, 1876;

FURGUSON JOHN farmer sec. 10; born in Scotland Oct. 9, 1832; came to country 1836; this Co. 1839; has lived here 36 years except seven years spent in Australia, England, Scotland and other places; his mother & sister live with him.

FIRESTINE J.G. butcher, Troy Grove

FOSTER C.F. P.M. and carpenter, Troy Grove;

FUNFSINN AUGUST farmer sec. 31; born in Germany Aug. 3, 1847; came to this Country, State & County in 1850; married Mary Schneider, Jan. 5, 1870; she was born this Co. Sept. 27, 1847; three children; Catherine, Anna, August Henry; lost one son;

FUNFSINN H. farmer sec. 31

GARDINER THOS. farmer; born in Ireland 1834; came to Canada 1847;

TROY GROVE TOWNSHIP – 1877

came to the U.S. lived in Oswego; came to Co. 1856; married Mary E. [Minnie] Crane fall of 1874; one child not yet christened;

GEPHERD JNO. farmer sec. 22;

GERLACH ANDREW storekeeper, sec. 35;

GIFT S. farmer sec. 15;

GOREHAM PATRICK laborer;

GREEN B.

GUTZELL WENDELL Gardener, Troy Grove;

HANEY J. farmer sec. 22;

HAPP ADOLPH farmer sec. 19; born in Germany March 29, 1830; came to this Country July 12, 1847; to this Co. same year; married Elizabeth Maubag Oct. 16, 1858; she was born in Germany; four children; Ellen, Lizzie, Peter, Katie;

HAPP A. rents farm;

HAPP JOHN farmer sec. 9; born in Germany Oct. 7, 1832; came to this Country and this Co. 1847; married Anna Knsipp Nov. 8, 1868; she was born in Germany and died Feb. 6, 1877; four children Charlie, Henry, John and Henry; lost four;

HAPP P. farmer sec. 19

HAPP WILLIAM JR. farmer sec. 18; born in Germany March 17, 1837; came to this Country, State and County 1847; married Kathrina Sundtrkef, Oct. 25, 1864; she was born in Germany, six children; Lizzie Eva, Mary, William, Annie and Edward.

HAPP W. SR. farm sec. 19;

HAYMAN P. farmer sec. 17;

HEIMAN PETER farmer sec. 17; born in Co. Nov. 1848; among the first persons born here; brother Matthew lives with him born 1856; his brother Philip lives in Amboy, Lee Co.;

HESS ABRAM farmer sec. 26; born in Lebanon Co., PA March 19, 1837; came to Co. in 1847; married Sarah J. Foulk

May 13, 1862; she was born Perry Co., PA Sept. 16, 1843; five children; Willie E., Harvey J., Alice A., Susie L., and Sadie M.

HESSEBERGER ELLAS W. farmer sec. 26; born Schuylkill Co., PA June 28, 1855; came to Co. 1873; his mother and sister live with him; rents from G.W. Huck;

HICKOK HORACE D. farmer sec. 27. married Martha Edwards; one son William J. born Dec. 29, 1875;

HICKOK L.B. farmer and supervisor sec. 27;

HOCHSTATTER THEODORE farmer sec. 27; born in Prussia Aug. 24, 1821; came to this country and Co. Aug. 1846; married Christine Kratz, Nov. 6, 1847; she was born in Prussia; four children; John, William, Helen and Peter; lost four children;

HOCHSTATTER WILLIAM farmer sec. 28; born this town and Co. Sept 29, 1853; he rents his fathers farm; married Eva Longeroth Oct. 26, 1875; she was born in Troy Grove this Co.; one child Mary Christina born Aug. 11, 1876;

HOFFMAN HERMAN farm;

HOFFMAN J.R. farmer sec. 34;

HOLCOMB NELSON farmer sec. 11; born in Lorain Co., Ohio March 14, 1835; came to this State & Co. when 2 yrs. old;

HOLESTON WM. farmer sec. 18;

HOSS WILLIAM farmer sec. 20;

born in Prussia March 24, 1816; came to this country & Co. 1845; married Elizabeth Pellicolan Feb. 1850; she died April 19, 1870; six children; Theodore, Adolph, William, Charlie, John & Mena;

HOUTZ W.G. physician

HUCK CHAS. FRED farmer sec. 26; born in Hamilton Co., Ohio Sept. 16, 1854; lived there 6 years lived in & WI four years coming to this Co. 1864; rents farm from his father; married Rebecca

TROY GROVE TOWNSHIP – 1877

Lahman Jan. 19, 1875; she was from Lima, Ohio; two children; Clarence Harrison and Rufus Ephraim;
HYBROOK G. rents farm;
HYDER JNO. rent farm;

JACKSON JOHN farmer sec. 36;
JACOBY DAVID SR. farms sec. 10;
JACOBY DAVID JR. farmer;

KAMPF FERDINAND farmer sec. 20; born in Prussia Nov. 1, 1838; came to U.S. 1847; came to this Co. June 1847; married Maggie Waldorf of Germany, Dec. 16, 1862; five children; Katie, Maggie, Amelia, Emma and Ferdinand
KEEF ED. Laborer

KEMFELTER GIDEON farm
KIDD JAS. [No.1] farm sec. 25;
KIDD JAS. [No.2] farm sec. 34;
KIDD JAMES farmer sec. 25; born in England April 13, 1820; came to this country June, 1845; lived in Chicago & Ohio; came to this Co. 1846; married Mrs. Elizabeth Edgecomb in 1850; she was born in England came to this country as infant; four children; Thomas, William, Benjamin, and John.

KIMPLE WM. farmer sec. 22;
KIERSTEATTER FRED farm sec. 25;
KIERSTEATTER HENRY farmer sec. 22; born Montour Co. PA, May 6, 1854; came to this State & Co. 1873; lived in Ophir one year; father, mother and sisters are living in this Co.

KISTER SEBASTIAN farmer;
KITSADER JNO. rents farm;
KLINE JOHN saloon keeper;
KLINEFELTER C. farmer;
KLINEFELTER CHRIS farmer sec. 26
KLINEFELTER DAVID farmer sec. 14
KLINEFELTER GIDEON farmer sec. 26; born this Co. June 20, 1852; married Susannah Jane Nash Feb. 24, 1876; she was from Wayne, DuPage Co. IL;
KLINEFELTER JACOB farm sec. 23;

KLINEFELTER JOHN farmer
KLINEFELTER JOSIAH farmer sec. 15; born in Lebanon Co., PA, Feb. 2, 1844; came to Co. & State 1849; married Hattie E. Remee, Aug. 6, 1865; she was from PA; three children; Addie Cora, Maggie A., Forney Alan;
KLINEFELTER NATHAN farmer
KLINEFELTER PETER farmer;
KOBLEMAN FRANK farmer sec. 7;
KOBLEMAN F. farm sec. 7;
KOBLEMAN H. farm sec. 7;
KOBLEMAN W. farm sec. 19;
KRATZ PETER farmer sec. 17;
KRAUSE C. general mdse, Troy Grove;
KRAUSE ERNEST clerk, Troy Grove;
KREISER AMOS farmer sec. 24; born in Twp. Sept 13, 1850; parents came here 1849; married Josephine Billow Nov., 1873; she was born Cumberland Co., PA; son Samuel born July, 1875;
KREISER D. farm sec. 34;
KREISER LEVI farmer sec. 23; born in Twp. July 21, 1853; Peter Kreiser born here Dec. 15, 1854; they both live on home place; Joseph Kreiser lives with them, parents are dead;
KREISER P. farm sec. 23;
KUNDER J.A. farmer sec. 35;
KUTENBAUGH FRANK farm sec. 16;

LAMPSON B.O. farmer sec. 25;
LAFFERTY JAMES laborer;
LAMPS M. farm sec. 32;
LAND ADOLPH farmer sec. 29; born in Prussia, May 9, 1847; came to this country Aug. 15, 1849; came to Peru, this Co. lived 5 years; MN 2 yrs; Iowa 9 yrs; married Maggie Ich Aug. 24, 1869; she was born in Prussia, Aug. 27, 1847; four children; Annie, Anton, Peter Joseph, Mary Catherine;
LAND A. farmer sec. 28;
LAND F. rents farm;
LENTZ PHILIP rents farm;
LEWIS JOS. laborer;

TROY GROVE TOWNSHIP – 1877

LINDEMIRE H. rents farm;

McCLAREN Jas. laborer;

McDANIEL DAN laborer;

McDONALD J. farm sec. 31;

McDONALD PAT farmer;

McDOWELL A.C. farmer sec. 27;

born in Cleveland, Ohio, July 10, 1854; came to this state 1857; married Cornelia J. Andrews, Feb. 28, 1877; she was born here; she owns 80 acres;

McDOWELL N. farm sec. 35;

McGINNIS J. rents farm;

McKEY W. A. farmer sec. Sec. 10;

McKEY WM. J. farmer sec. 10; born in Candor, Tioga Co., N.Y., June 11, 1833; came to Lamoille, Bureau Co. May 4, 1852; was in mercantile business; came to this Co. 1865; married Victoria Kendall, [daughter of Dr. John Kendall, early Bureau Co. settler]

Feb. 17, 1856; five children Stella,

William Milroy, Fannie Reeve, Mary Alice, Alexander W., lost one daughter;

McLAUGHLIN E.C. laborer;

McLAUGHLIN SILVESTUS farmer sec. 35; born in Troy Grove, July 25, 1844; was in 132nd I.V.I., Co. A; married Emma Marie Smith March 18, 1871; she was born Wilkesbarre, PA., March 18, 1848;

McMAN JAS. laborer;

McPHERSON J. farm sec. 25;

MALONEY R. farm sec. 35;

MATTES ANDREW farmer sec. 18; born in Germany Feb. 28, 1837; came to U.S. May 16, 1861; to this Co. same year; married Julia Shultz Feb. 9, 1864; she was from Peru, this Co.; Seven children; Mary, Barney, Lizzie, Annie, Agnes, Katie, Matthias.

MEHL L. farmer sec. 26;

MEINARD F. farm sec. 35;

MEINARD M. Troy Grove Water Mills; sec. 35; born in Prussia Dec. 15, 1808; came to U.S. Dec. 15, 1853; came to this

Co. 1854; married Mary Margaret Theilman from Prussia, in 1831; she died in 1872; six children; Jacob, Henry, Fred, Adolf, Eberhart; one son died in army; one son killed in Ottawa; Fred of Troy Grove Mills, born in Prussia 1840; came 1853; married Amelia Yitt of MO 1868; two children Henry and Rudolf

MILLER HENRY with Krause storekeeper in Troy Grove; born in Schuylkill Co., PA, Feb. 12, 1838; came here 1858; was in Army- 64th I.V.I.; married Louisa Eckert Christmas Day, 1859; she was from Berks Co., PA; One son; William Henry born April 18, 1860;

MILLER LEWIS rents farm;

MITTEN JOHN H. farmer sec. 36; born in Essex Co., N.J. April 11, 1849; lived there about twenty years, lived in Ohio; came here 1860; rents farm of D.S. Ransbarger ; was in Army 12th I.V.I.; married Almira B. Ransbarger in Sept., 1862; she was born here; five children; three daughters, two sons.

MITTEN H. rents farm;

MOYER LEWIS rents farm;

MOYER MORGAN farmer sec. 10; born in Schuylkill Co., PA April 30, 1845; was on the Delaware & Raritan Canal six years; has lived here twelve years; married Rosa Hessenberger from Schuylkill Co., PA in 1867; four children; Katie, Minnie, Ida and Georgie

MUNDIE JNO. farm sec. 10;

MURPHEY P. farm sec. 31;

MURPHY THOS. rents farm;

MYERS URIAS farmer sec. 25; born in Perry Co., PA, Dec. 28, 1840; came here in 1850; married Alvina Gephart, Jan. 2, 1862; she was from Lebanon, PA; have six children; Emma Jane, John Henry, Charlie Allen, Nora Jane, Katie, Edna.

NEITSCHER JOHN farmer sec. 29;

NEW NICH. rents farm;

TROY GROVE TOWNSHIP – 1877

OLDS JEREMIAH farmer sec. 5;

PANTON BENJ. Miller;

PEARL D.A. laborer;

PETERS JAS. farmer sec. 36;

PITSTICK HENRY farmer sec. 6; born in Germany Aug. 27, 1842; came to this country and county spring of 1847; married Ann Littershite, from Germany, June 21, 1862; she came to this country when eight years old; six children; Ann G., Lizzie, Frank, John, Willie, Ella; lost one daughter Mary.

PORTERFIELD JAS. farmer;

PORTERFIELD ROBERT farmer sec. 6; born in Armstrong Co., PA, Feb. 13, 1827; lived there twenty-seven years, in MI three years coming here in 1857; married Mary Jane Dickey of Armstrong Co., PA Nov. 30, 1852; four children; Sarah Jane, James D., Mary E., Robert E.; lost one son Marshall K;

PORTHOFF THEO. rents farm;

QUANDAL FRED laborer;

RANSBARGER GEO. Rents farm;

RANSBARGER DAVID S. retired farmer, Homer, born in Butler Co., Ohio, May 6, 1808; lived in Ohio & Indiana twenty two years; came to this state Oct. 14, 1830; this Co. 1833; married Rebecca Evans March 6, 1834; she was born Licking Co., Ohio, April 1, 1815; five children; Mrs. Emily E. Gibberson, Mrs. Sarah M. Zorn, George W., Mrs. Almira B. Mitten; lost one daughter.

RAY M.F. farm sec. 12

READY HENRY teamster;

RICK A. farmer sec. 20;

RICK P. farm sec. 21;

REED F.O. teamster;

REED WM. H. laborer;

REEDER DAVID laborer;

ROACH J. M. laborer;

ROETZEL WILLIAM farmer sec. 8; born in Peru, La Salle Co., March 15, 1854; lived there 1 ½ years moved to MN. returned to Mendota 24 years ago; rents his fathers farm; married Regena Schoemnschoefer, May 17, 1876; she was born in Germany; one child Augusta born Dec. 23, 1876;

ROOTSTILL G. farmer sec. 8;

SALYARDS M.L. laborer;

SCHEIDENHELM C. rents farm

SCHEIDENHELM J. rents farm

SCHEIDENHELM L. farm sec. 3;

SCHEMPH C. works in stone quarry;

SCHNEIDER JOHN farmer sec. 30;

born here Aug. 27, 1852; married Catherine Fumfsinn, Feb. 1, 1874; she also born here; two children Henry, John Peter.

SCHMITZ J. rents farm;

SCHUTZ HENRY rents farm;

SCHUTZ JOHN rents farm;

SETCHEL H. farm sec. 2;

SETCHEL M. rents farm;

SETCHEL MARION rents farm;

SHORT A.J. shoemaker; Troy Grove

SHORT JACOB shoemaker; Troy G.

SHORT S. blacksmith; Troy Grove;

SIMPSON FRANK laborer;

SIMPSON W. farmer sec. 35;

SIMPSON WM. M. carpenter, Troy G.

SKEFFINGTON D. farm sec. 29;

SKEFFINGTON MICHAEL farmer sec. 12; born in Canada 1842; came to Bureau Co, IL 1862; lived there till fall 1865; went to MN; went to MT in 1866; there until 1872 mining; came to La Salle Co.;

SKILES JAS. rents farm;

SMITH A. farms sec. 33;

SMITH A. H. farms sec. 35;

SMITH HENRY farmer sec. 25; born in Columbia Co., PA, April 1, 1822; 1852 came to Dixon, Lee Co., IL; came here 1859; was Bridge Builder for Ill. Central

TROY GROVE TOWNSHIP – 1877

R.R. six years; married Sarah Ann McBride, Sept. 1848; she was from Columbia Co., PA; two children; Mrs. Emma Mc Laughlin, Mrs. Effie Ann Ransbarger; lost son;

SMITH JOHN rents farm;

SMITH P. farmer sec. 16;

SNYDER A. farm sec. 11;

SNYDER J. farm sec. 30;

SONDGEROTH C. farm sec. 17;

SONDGEROTH H. farm sec. 9;

SONDGEROTH PETER farmer

SPITLER A. rents farm;

SPITTLER JACOB farmer sec. 23;

born here May 21, 1849; farms home place; married Ellen Collins, July 3, 1877; she was born in Dodge Co., WI, July 9, 1857; came here 1872;

STEPHENSON J. blacksmith;

TRAGER E.H. laborer;

TAYLOR WM farmer sec. 26;

THELO CHARLES farmer sec. 30;

born in Prussia, July 11, 1828; came to this country & county 1848; was in army – 55th Illinois Infantry, Co. I; was wounded May 22, 1863, in second charge of Vicksburg; also wounded at Shiloh; married Ellen Kaemerer, July 26, 1852; she was born in Prussia, July 8, 1828; ten children; John, Charles, Henry, Frank, William, Fred, Caroline, Sophia, Anna, Rebecca;

THOMPSON THEO. Laborer;

THURSTON A.J. farm sec. 4;

THURSTON WELCOME farm sec. 9;

TOWER A.C. farm sec. 7;

TOWER CHAS. farmer;

TRIMPLER CHRIS. farmer sec. 30;

TURNER N.C. farmer sec. 2;

TWEED WM. farmer sec. 34;

WAHL JNO. farmer sec. 29;

WALDORF MARGARET widow sec. 9; born in Germany, Oct. 17, 1817; came to this country & county 1853; married

Philip Waldorf March 18, 1844; he was born in Germany 1813; she has six children; Maggie, Katie, Lewis, Philip, William, Peter; son Philip was born in Germany, Aug. 5, 1850; came to this Co. in 1853; married Amelia Meisenbach, Feb. 26, 1874; she was born St. Louis, Jan. 24, 1853; son Lewis born Feb. 24, 1876;

WALDORF P. farmer sec. 5;

WALZER WILLIAM farmer sec. 30;

born in Peru this county May 18, 1853; lived there seventeen years; rents farm of his father; married Barbara Devora March 26, 1877; she was born in Germany, came here age 1 ½ years;

WARNER J. laborer;

WATSON J. farmer sec. 3;

WEBER J. farmer sec. 21;

WEBSTER CHAS. C. farmer sec. 12;

born Hartford Co., Conn. Feb. 3, 1806; came here 1834; married Ann Worsley of Washington D.C., in 1829; she died in 1875; six children; four sons, two daughters; lost three children;

WEBSTER JOSE farmer;

WHALEN ANDREW farmer sec. 31;

born in Ireland Aug. 1 1828; came to this country 1832; lived in N.Y. four years; lived in PA eight years; came to this county 1844; married Mary Pantenburg May 17, 1857; she was from Prussia; six children; John, Margaret, Gertrude, Mary, Andrew, Michael; lost one daughter Catherine;

WIGANT S. rents farm;

WILKINS J.E. laborer;

WILLIAMS S. farm sec. 24

WILLS GEORGE E. farmer sec. 4;

born in Detroit March 22, lived in MI fifteen years also lived in PA. here 1856; married Mary Bunker of Jackson Co. MI, Sept 20, 1864; she born Jan. 30, 1842; died Feb. 8, 1877; five children; Jennie M. June 19, 1865; James S. Oct. 16, 1866; George A. Jan. 13, 1870;

TROY GROVE TOWNSHIP – 1877

Oscar Oct. 25, 1871, Edgar B. June 16, 1873;

WILLSHAY WILLIAM farmer sec. 36

Born in Prussia, Dec. 1846 came to country & county Oct., 1848; married Mary Drummer May 22, 1876; she born Bureau Co., IL; girl Caroline Apr. 3, 1877;

WIXOM C.S. farm sec. 11;

WIXOM J.A. farm sec. 34;

WORSLEY MRS. CAROLINE M.

widow; sec. 13; born Broome Co., N.Y. June 13, 1813; came here 1832 with brother Pliny Dewey; married Frederick W. Worsley March 1, 1830; he born District of Columbia, Dec. 28, 1806; died May 3, 1847; six children; Mrs. Susan D. Eastman, Mrs. Harriet M. Parsons, Julia R., Annis J., William H., Leonidas J.; lost daughter Bertha J.;

WORSLEY FRED rents farm;

WORSLEY J.T. farm sec. 22;

WORSLEY J.L. farmer;

WORSLEY WM. G. farmer sec. 10;

born in Washington D.C. Jan. 4, 1817; went to Ohio lived there fifteen years; came here 1834; married Louisa M. Cooper of Franklin Grove, Lee Co., Nov. 12, 1844; three children; Katie A., Henry H., Lyle Don;

YOST FRED farmer sec. 35;

ZIMMERMAN D.J. farmer;

ZIMMERMAN J. farm sec. 5;

ZOLPHER HENRY stone mason; sec. 9; born in Prussia Feb. 7, 1830; came to this country & county May 1, 1852; lived in Peru, IL fifteen years; helped build first house in Mendota; married Eva Treker July 4, 1855; she was born in Prussia; came to America 1852; died July 24, 1864; four children Henry, Katie, Lizzie, Peter Joseph; lost one daughter Josephine;

ZORN CHAS. Restaurant, Troy Grove;

[source The Past and Present of La Salle County 1877]

Stirring times in Troy Grove

March 13, 1903

Brave acts of two Illinois Heroines are told in the story connected with the resignation of Mrs. Harriet M. Foster as postmistress of Troy Grove, in this county. After a continuous service of over half a century, Mrs. Foster has been relieved on her own request and has been thanked by the postal department. W.P. Wixom will be appointed to fill the position.

The office at Troy Grove was established in 1836. Mrs. Foster's accession came in 1849, when Zachary Taylor appointed her father, Marmaduke Masterman postmaster. Harriet, the youngest child in a family of ten children and the wife of Charles F. Foster, was made assistant postmaster, and to her fell the duties of the office. Mr. Masterman died in 1861, when Abraham Lincoln, appointed Mr. Foster postmaster but his wife continued to perform the duties of the office.

In 1864 Mr. Foster and his son Frank enlisted in the Union Army, and the wife was left to care not only for the post office, but for eight children of her family.

When husband and son came back from the army the latter had contracted smallpox, and the whole family was infected. The old house with its post office was quarantined.

Jane Louis, now living at Troy Grove was the heroine of the occasion. She was the wife of a bugler who had gone to the front, and the mother of a large family of children, but went to nurse the Foster family and with the aid of a physician nursed all but three of them back to life. Frank and two of his brothers died. This was the only break in the service of Mrs. Foster to the government. While she was in quarantine the mails were received and distributed by other hands. In 1877 Mr. Foster resigned the office and for the first time Mrs. Foster held the position in her own name. During all this time the post office had been kept in one house. The place has undergone changes, but it has housed the Troy Grove post office from the time of President Taylor.

[source Ottawa Daily Times]

[Thanks to Helen Crawford]



4. ZORN / OLD LUTHERAN
5. TROY GROVE
6. METHODIST EPISCOPAL

TOWNSHIP 35-N. RANGE 1-E.

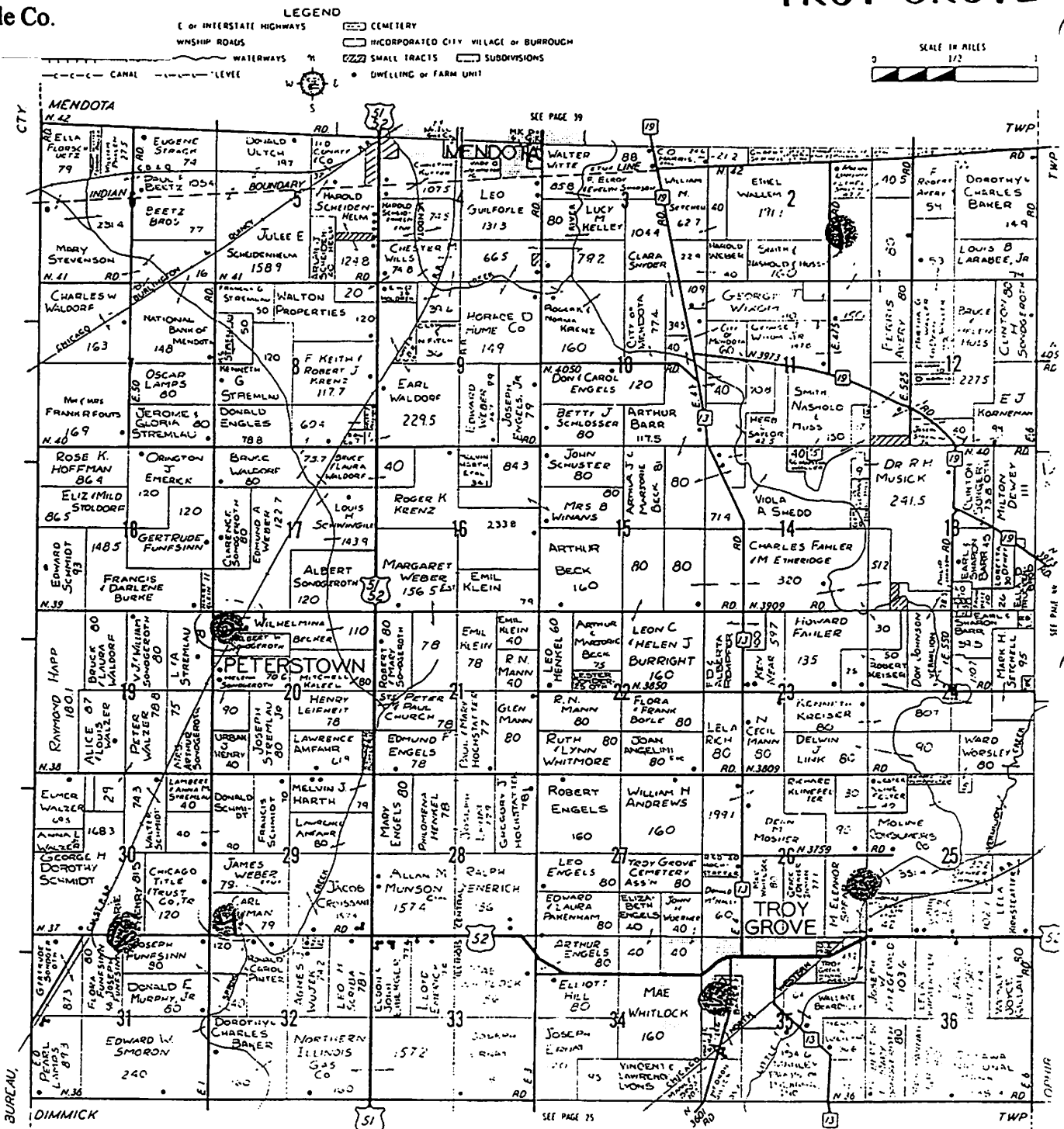
TROY GROVE



Town & Country Publishing Co., Inc.

- 
- 

PHONE: (219) 362-8508

• P.O. BOX 689 • LA PORTE, IN 46350 •

ORANGE COUNTY CALIFORNIA
GENEALOGICAL SOCIETY



Reddick Mansion - Ottawa

Pictured above is Reddick Mansion where the Ottawa Visitors center is located. It is across the street from Washington Park and the Appellate Court Building in down-town Ottawa. Several places that should be on your 'must - see' list when visiting this area.

Listed below are places to stay while in Ottawa. Additional information on the facilities can be obtained at the Ottawa Visitors Center, at 100 W. Lafayette St., in the Old Reddick Mansion. The Center's phone number is (815) 434-2737 or (888) 688-2924.

The web site: www.visit-ottawa-il.com

Ottawa Hotel Properties and B&Bs

Comfort Inn: 510 East Etna Road, phone (815) 433-9600, (800) 228-5150.

Holiday Inn Express: 120 West Stevenson Road, phone (815) 433-0029, (800) HOLIDAY.

Ottawa Travelodge: I-80 & Route 23, phone (815) 434-3400.

Hampton Inn: 4115 Holiday Lane, phone (815) 434-6040, fax (815) 434-6045

Sand's Motel: 1215 LaSalle St., phone (815) 434-6440.

Super 8: 500 Etna Road, phone (815) 434-2888, (800) 800-8000.

Surrey Motel: Route 23, phone (815) 433-1263.

Prairie Rivers Bed & Breakfast: 121 E. Prospect Ave., phone (815) 434-3226.

Marcia's Bed & Breakfast: 3003 N. Route 71, phone (815) 434-5217.

The Devil Lurks

"The oldest graves are found in the south part of a churchyard, as it was the custom to avoid the shadow of the church falling across the graves. For in the shadows lurked the Devil and, as every good man and woman knew, the Devil always rode in from the north. In Victorian times, the extreme north side of the churchyard was reserved for suicides."

[extracted from Sarasota Gen. Soc. News, Dec 1999-Jan 2000 via Kinfolks Search, Reynolds Co. Gen. & His. Soc., Inc. July 2002; SCG Society, Memphis, MO, V16, No 4, Oct 2002]

Flu Epidemic of 1918

A story of the "Spanish Influenza" epidemic of 1918 appeared in a 1953 issue of the Ottawa Daily Republican-Times (now the Daily Times). In October alone of that year 57 Ottawans passed away. In the New Year's edition of 1918, it took six lines of type to list the June deaths and 72 lines for the October deaths. Harry Funk of Gladfelter's recalled that his firm took all the ambulance calls since the Gladfelter vehicle was the only one in the city. During the fall months of that year and on into 1919, the citizens of the city remained indoors, and public places, schools and business houses were closed in an attempt to ward off the disease.

The first death reported that came from the flue was that of Peter F. Boyle who passed away while in the service at Great Lakes. 57 deaths were recorded in a single month - the well-remembered October of 1918. Funk recalled that "We could take only the sickest from each household because of the lack of space." The Ottawa Boat Club was turned into an emergency hospital, and the Mason Temple also offered its facilities. Private funerals became mandatory, and the fire department washed down all the streets.

The first death reported that came from the flu was that of Peter F. Boyle. Some others known to have perished beside Boyle included Carl Lutz, J. C. Goodnetter, Carl Orsinger, Mrs. W. F. Gerding, her son, Fred Gerding who died at Camp Taylor, KY, and Mrs. George L. Farnsworth. Other service men who died: Thomas White at Camp Grant, Leonard Olson at Camp Hancock, GA, William Lanigan at Camp Grant, and Harold F. Anderson at Camp Sherman. The epidemic had no sudden end. People died from the flu on into February of 1919. There were no final or accurate figures on the number of deaths, only estimates that were made.

Many Donations Received

We've been fortunate in having a number of members give the Guild donations over the past few months, and we wish to thank them. Sometimes the name of a donor slips through the cracks, and your name is missed (for which we apologize). Names of donors given in alpha order:

Ken Brodbeck, Darlene Budde, Edith A. Dady, Melanie Hallam, Mary Hasselbring, Ronald W. Hoppel, Bob Jordan, William H. Kidd, Paul E. Lipka, Robert J. Martin, Robert A. McClevey, Beverly Riegert, Bill and Joan Sanders, Erika Schmidt, Loren L. Schmitz, Ambrose and Shirley Tappe, Geraldine M. Vernick, Betty J. Weber and Dorothy White.

A Quote from Correspondence to the Family History Library

A 14-year old boy wrote: "I do not want you to do my research for me. Will you please send me all of the material on the Welch line, in the U. S., England, and Scotland countries? I will do the research."

Pastors of LaSalle County Churches Immanuel Luther Church-Eden Township

Rev. J. Ritter	1862-1864
Rev. H. Sickmann	1864-1866
Rev. L. Austmann	1866-1869
Rev. W. Krebs	1870-1874
Rev. H. Staehlin	1874-1879
Rev. A. Johnson	1880-1883
Rev. R. Baumann	1884-1905
Rev. A. Blasberg	1905-1915
Rev. C. Storek	1916-1920

Marriages Were Scarce In County in 1834

[Ottawa Newspaper-20 January 1934]

Faded hand writing, but still legible, of Joe Cloud and David Walker, county clerks of a century ago, in the old book of marriage licenses in the county clerk's office, give a record of romance of those old and brave days.

The thin little book, which has in it all the marriage licenses issued in LaSalle county from its organization in 1831 to 1850, when the book was filled, is one of the treasured relics of the county. Then the county took in all of Grundy and Kendall counties and part of Livingston and Putnam, up to 1837.

The records show that there were but 14 marriages performed in all that thinly peopled territory of virgin rolling prairies and tracts of giant timber trees, the best stand the nation ever knew, in the midwest, in 1834.

Romance flourished then as it does now. The darts of Cupid were effective a hundred years ago and the scent of roses, on moonlight nights, and the great harvest moon hanging in the eastern sky, was a potent factor in promoting marriages among the pioneer belles and swains.

Cloud and Walker divided the duties of keeping the county records in the little old log court house. Walker was elected to the office in the autumn serving until 1842. In the same way George E. Walker and William Stadden split the sheriff's duties in 1834. Walker being replaced by Stadden.

The record of marriages for the county, with the names of happy couples, the time of the marriage and the name of the officiating minister or justice of the peace are as follows:

January 1—Margaret Trumbo and John Armstrong. Lester Robbins, justice of the peace.

January 26—Nancy Green and Joseph Dunnavan. David Shaver, justice of the peace.

March 6—Rebecca Evans and David Robbins. G. Jones, justice of the peace.

April 10—Ann Halterman and Isaac H. Reynolds. Daniel Kellogg, justice of the peace.

May 26—Eleanor Long and Washington Owens. Daniel Dimmick, justice of the peace.

June 19—Sophia Babock and James Gunsalus. William Royal, justice of the peace.

July 13—Elizabeth Rolf and Oliver J. Johnson. Joseph Cloud, justice of the peace.

Marriages-1834 continued

October 3—Polly Ward and Christopher Long. William Seely, justice of the peace.

October 12—Mary Folf and Zachariah Neilsquire (?)—(the name is undecipherable). Joseph Cloud, justice of the peace.

October 26—Louis Brown and Calvin Eels. Rev. E. H. Hazard.

November 2—Harriet States and Jacob Bass. William Seely, justice of the peace.

November 19—Mary House and James H. Turner. H. E. Clark, minister of the gospel.

December 9—Ruth Gillett and Simon Cooley. S. R. Beggs, minister of the gospel.

December 24—Minerva Dimmick and James Manning Leonord. Rev. E. H. Hazard.

Emigrate, Immigrate, Migrate

What is the difference between *emigrate* and *immigrate*? Don't they both *migrate*?

*Ed. Note: This particular question was asked of Miss Ima G. Bugg, the lighthearted research associate of The Journal, Shreveport, LA. Genea. Soc. Her answer struck "my funny bone" as it answered the question so succinctly that anyone could remember the differences. Her answer:

Dear Gypsy: Those three words have three distinct meanings. *Emigrate* and thus *emigration* is moving out of a country. One could say most of our ancestors *emigrated* from Europe, Africa or Asia. Of course, some of us had ancestors greeting these *immigrants*, which brings us to the second term. *Immigration* is moving into a country. *Migration* is moving about within a country's boundaries. My ancestors *emigrated* from the British Isles. They were *immigrants* in Delaware. Then they *migrated* to South Carolina.

Emigrate: get on the boat.

Immigrate: get off the boat.

Migrate: get in the covered wagon.

[source: SCG Soc. newsletter, Oct 2002. via The Journal, Vol

His Own Appraiser

"Willie," said his mother on her return from a shopping expedition, "I told you if you were good while I was out you might have a piece of candy, and now I find you've taken all there was in the box."

"Yes, mamma," replied Willie, "but you've no idea how very good I've been."

[The Ottawa Fair Dealer—June 4, 1915]

Playing Cards Date Back To Middle Ages

Ottawa area card players may be interested to learn that playing cards are thought to have originated in Hindustan around 800 A.D.

During the Middle Ages, jacks, queens and kings ("face cards"), were named for legendary, historical and Biblical figures.

The Spectator recently did a bit of research on the subject, and learned that the proper name for the King of Hearts is Charlemagne, Emperor of Rome, founder of the Roman Empire.

The King of Spades is David, who slew Goliath. The King of Diamonds represents Julius Caesar. The Queen of Clubs is Elizabeth I of England.

Judith, who the Bible says killed an Assyrian general to save Israel, is the Queen of Hearts. Athena, the Greek goddess of war and wisdom, is the pseudonym for the Queen of Spades. The Queen of Diamonds represents the Biblical Rachel. The Queen of Clubs is Elizabeth I of England.

La Hire, a French warrior who fought with Joan of Arc, earned the title of the Jack of Hearts. The Jack of Spades stands for Hogier, cousin of Charlemagne and a Danish hero. The Jack of Diamonds signifies Sir Hector, a Knight of the Round Table and half-brother of Sir Lancelot. The Jack of Clubs is Sir Lancelot himself, chief knight of King Arthur's Round Table.

The suits in a deck of playing cards represents the four ranks of society in the Middle Ages. Hearts are churchmen and statesmen; spades, the military; diamonds, the merchants; clubs, the peasants and workers.

The earliest playing cards in Europe were those used in Italy during the 14th century. During the French Revolution, playing cards were forbidden by law. Then the kings, queens and jacks became sages, virtues, and heroes.

[extracted from the Daily Republican Times, July 30, 1970]

When Surnames Disappear

Only 20% of the surnames used still exist after 13 generations. Ninety percent of all families from the 1700s are now extinguished. In 1974, the Social Security Administration had 1,285,556 different surnames on file, of which 448,663 had only one occurrence. Over 5,000 surnames of the knighthood in the Domesday Book of 1086 have died out.

[Treasure Chest News, Cent. FL Gen Soc Inc]

Tombstone Epitaph

Oops! Harry Edsel Smith of Albany, N.Y.:
Born 1903 - Died 1942

Looked up the elevator shaft to see if the car
was on the way down.

It was.

Twelve Rules For Good Documentation

Documentation in your genealogical research is important. It prevents duplication and it allows the individual to evaluate the sources. The following twelve items are a good rule of thumb to go by in the process of documentation of your research.

- 1 Document as you go
- 2 Enter notes in a consistent format
- 3 Use confidential information with discretion and sensitivity
- 4 List all sources found
- 5 Identify conflicting or missing information
- 6 Avoid using abbreviations
- 7 Indicate additional research where needed
- 8 Strive to obtain primary sources for each event
- 9 Indicate the location of lengthy documents rather than restating
- 10 Welcome input and constructive review of your documentation
- 11 Identify all researchers' contribution including your own
- 13 Recognize that good documentation requires a process of continuous refinement

[American-Canadian Genealogist, Vol 189, No2, Spring 1993]

Odd Burials

Not long ago there died in a north London suburb a lady who wished to be buried in the bedstead in which she had lain continuously for nearly a quarter of a century prior to her decease, and to insure, as she thought, her wishes being respected she left a plump contingent legacy to a relative. As the bedstead in question, however, was of the old "four post" variety, and an unusually massive specimen at that, the cemetery authorities objected. Eventually a compromise was effected. The bedstead was taken to pieces, and from the timber so obtained a sort of box coffin was constructed for the reception of the remains.

It is, however, among the mining population that instances of funeral eccentricity are most common. Jack Hustler, a coal hewer of Tong, near Leeds, who died the other day at the age of 67, was buried in a coffin constructed to his own specification 20 years ago. It was made of pitch pine, with silver handles, and the lid was hinged at one end. The deceased was buried with a lump of coal which he had carefully preserved for years. It served as his pillow, and his tobacco and pipe also found a place beside him. This latter custom is said to be very prevalent among the coal miner. The tin miners of Cornwall almost invariably include an umbrella among the coffin "furniture."

It would be interesting to learn the origin and significance of this strange use.—London Express.

[The Fair Dealer-July 22, 1900; Ottawa]

Happy New Year

1850 Mortality Schedule Ottawa, LaSalle County, IL

Name	Age	Sex	Mar.	Birth P.	Mo died	Occup.	Cause	Dur.
Susan Forbes	2/12	F		IL	Sep		Dysentery	5 days
Evert LaGrange	22	M		NY	Jul	Lawyer	Cholera	3 days
Austin Welch	10/12	M		IL	Dec		Inflam. Bowels	10 days
Jemima A. Shuler	9	F		IL	Jun		Dropsy Brain	10 days
Peter Devereux	2	M		IL	Jul		Scarlet Fever	7 wks
Mary A. Redman	8	F		IL	Jun		Scarlet Fever	4 days
Sarah Jane Cotton	2	F		IL	Jun		Scarlet Fever	3 wks
Alanson King	33	M	M	NY	Nov	Sash Maker	Abcess of Liver	2 wks
Willis G.C. King	4	M		IL	Jun		Scarlet Fever	3 wks
Patrick Kelly	21	M		IR	Sep	Laborer	Brain Fever	10 days
Thomas Fannerty	7/12	M		IL	Jun		Lung Fever	5 wks
Mary E. Smith	3/12	F		IL	May		Small Pox	7 days
Martha Hudson	38	F	M	DE	Apr		Unknown	4 days
Mary Fanning	31	F		IR	Sep		Child Birth	10 days
Lucy E. Bell	7	F		IL	Aug		Cholera	1 day
John P. Lindley	1	M		IL	Aug		Unknown	6 wks
Hannah Headley	64	F	W	NJ	Aug		Cholera	2 days
Wm. N. Miller	25	M		IN	Nov	None	Cripple-Unknown	4 wks
Dennis Casey	51	M	M	IR	Aug	Laborer	Cholera	3 wks
Maria Casey	43	F	M	IR	Aug		Cholera	1 day
Rosina M. Blake	4	F		IL	Jun		Consumption	6 mos
Emeline A. Dow	1	F		IL	Jun		Inflam. Brain	7 days
Mary Chaney	1	F		IL	Jul		Unknown	5 days
Ann Brady	49	F	M	IR	Jul		Diahrea	3 mos
Michael Duffy	52	M	M	IR	Aug	Laborer	Sun Stroke	Sudden
John Blansfield	3	M		IR	Aug		Scarlet Fever	10 days
John Hackett	56	M	W	IR	Dec	Laborer	Diahrea	3 mos
Elizabeth Hackett	52	F	M	IR	Oct		Diahrea	2 mos
Thomas H. Mulligan	1	M		RI	Jul		Unknown	3 mos
Edward Bartlett	7	M		IL	Jun		Scarlet Fever	2 days
Rachel E. Hight	9/12	F		IL	Aug		Summer Complt.	7 days
Wm. E. Burgess	9/12	M		IL	Oct		Dysentery	6 wks
Margaret Clary	1	F		IL	Oct		Cholera	3 days
Rosalin Stouffer	50	F	M	FR	Aug		Cholera	4 days
George L. Gartman	3	M		IL	Aug		Worms	1 day

[Enumerated by W. H. L. Wallace, page 473]

Humorous Rules for Genealogy

- 1 Thou shalt name your male children: James, John, Joseph, Josiah, Abel, Richard, Thomas, William.
- 2 Thou shalt name your female children: Elizabeth, Mary, Martha, Maria, Sarah, Ida, Virginia, May.
- 3 Thou shalt leave NO trace of your female children.
- 4 Thou shalt, after naming your children from the above lists, call them by strange nicknames such as: Ike, Eli, Polly, Dolly, and Sukey—making them difficult to trace.
- 5 Thou shalt NOT use any middle names on any legal documents or census reports, and only where necessary, you may use only initials on legal documents.
- 6 Thou shalt learn to sign all documents illegibly so that your surname can be spelled, or misspelled in various ways: Hicks, Hix, Hixe, Hucks, Kicks.
- 7 Thou shalt, after no more then 3 generations, make sure that all family records are lost, misplaced, burned in a fire, or buried so that NO future trace of them can be found.
- 8 Thou shalt propagate misleading legends, rumors, vague innuendo regarding your place of origination.
- (A) you may have come from England, Ireland, Scotland, Wales—or Iran.
- (B) you may have American Indian ancestry of the ____ tribe.
- (C) you may have descended from one of three brothers that came from ____.
- 9 Thou shalt leave NO cemetery records, or headstones with legible names.
- 10 Thou shalt always flip thy name around. If born James Albert thou must make all the rest of the records in the names of A Albert, AJ, JA, AL, Bert, Bart, or Alfred
- 11 Thou shalt leave no family Bible with records of birth, marriages, or deaths.
- 12 Thou shalt name at least 5 generations of males, and dozens of their cousins with identical names in order to totally confuse researchers.
- 13 Thou must also flip they parent's names when making reference to them, although "unknown" or a blank line is an acceptable alternative.

[author Unknown]

Mortuary Record of LaSalle County 1896

[Ottawa newspaper-January 3, 1897]

January

Jan. 7 Mrs. Dr. Richey at County Asylum
Jan. 15 Rev. M. K. Whittlesey, Ottawa
Jan. 21 Mrs. A. E. Bach, Ottawa
Jan. 24 Dr. R. F. Dyer, Ottawa
Jan. 28 Edward Teal, Miller Township

February

Feb. 2 Miss Laura Bailey, Ottawa
Feb. 5 Mrs. Catherine Cahill, Ottawa
Feb. 6 Miss Elizabeth Trainor, Ottawa
Feb. 7 Henry Eichelberger, Ottawa
Feb. 11 Mrs. Hannah McMullen, Ottawa
Feb. 14 Mrs. Rosa Weaver, Freedom
Feb. 24 John B. Rice, Ottawa
Feb. 25 Mrs. Sophia Battger, Ottawa
Feb. 26 George Beatty, Ottawa

March

Mar. 6 Arthur Huff, Bradford Junction
Mar. 10 Mrs. John D. Mitchell, Ottawa
Mar. 13 Mrs. Moses D. Calkins, Ottawa
Mar. 17 Joseph Deilaboe, Ottawa
Mar. 17 Mrs. M. Ennis, Seneca
Mar. 21 Ralph Gridley, Ottawa
Mar. 23 Mrs. H. D. Olmstead, Ottawa
Mar. 24 George Jobst

April

Apr. 3 Mrs. J. Wood, Ottawa
Apr. 3 Henry Raub, Ottawa
Apr. 5 Mrs. Louisa R. Brundage, Ottawa
Apr. 11 Col. W. L. Gibson, Eldorado, Kan.
Apr. 11 John Furze, Ottawa
Apr. 12 Mrs. C. C. Glover, Ottawa
Apr. 18 Dr. C. Hard, Los Angeles, Cal.
Apr. 19 James Holmes, Mendota
Apr. 23 Mother Euphrasia, Convent, Ottawa

May

May 4 John Mosher, Streator
May 6 Mrs. G. E. Penny, Ottawa
May 6 Thos. Brennan, Nebraska
May 7 Ernest Blake, Chicago
May 17 Ambrose Jordan, Austin, Ill
May 27 John P. Flick, Ottawa
May 28 Mrs. A. H. Taylor, Ottawa
May 27 S. E. Gleason, Ottawa

June

June 5 Henry Holcomb, Marseilles
June 6 Mrs. C. L. Ballard, Ottawa
June 16 R. J. Hornick, Grand Ridge
June 18 Mrs. Charlotte Adams, Ottawa
June 21 Mrs. John de La Chapelle, Ottawa
June 26 Paul Kunert, Ottawa

Mortuary Record-1896-continued

July

July 2 Miss Dauphine Carr
July 2 Miss Ira Conover, Utica
July 5 Mrs. Isaac Ackerman, Ottawa
July 22 Jason Ashley, Tonica

August

Aug. 3 Alderman Hanson, Ottawa
Aug. 4 John Carlin, Ottawa
Aug. 13 Son of W. J. Sinon, drowned.
Aug. 18 John Klink, Ryburn Hospital
Aug. 26 Theo. Wallner, killed by train near Ottawa

September

Sept. 5 B. B. Griffith, Ottawa
Sept. 16 Mrs. Jas. Green, Ottawa
Sept. 24 Miss Lila Bower, Sheridan

October

Oct. 1 Supervisor Mitchell, Streator
Oct. 4 W. J. Rulison, Seneca
Oct. 8 Mrs. R. Taylor, Mendota
Oct. 9 Moses Degen, Davenport, Ia
Oct. 26 Mrs. James Patterson, Ottawa
Oct. 29 Miss Jennie Bailey

November

Nov. 4 Mrs. Sarah Fowler, Sheridan
Nov. 5 Mrs. Jos. Hall, Wedron
Nov. 15 Mrs. A. O. Pearson, Ottawa
Nov. 17 Arthur Lockwood, Ottawa
Nov. 19 Elisha Thompson, Freedom
Nov. 25 Mrs. Maria Irwin, Ottawa
Nov. 26 Wm. Emerich, Chicago

December

Dec. 4 Mrs. S. R. Blanchard, Ottawa
Dec. 4 Michael Sulzberger, Ottawa
Dec. 6 Mrs. Weaver, Farm Ridge
Dec. 10 H. J. Gillen, Ottawa
Dec. 11 C. L. Simon, Ottawa
Dec. 12 H. C. Nash, Chicago
Dec. 14 D. L. Grove, Ottawa
Dec. 16 Mrs. J. N. Fleming, Manlius
Dec. 18 Miss Dora Colwell, Ottawa
Dec. 28 David Batcheller, Ottawa

Information about all Federal Census taken from 1790 to the present.

The Web Page below is a link to information about all the census to the present time. It includes all the questions asked and how to interpret them. These were the instructions that were given the census taker. If you print it out, it will take 149 pages. It is in Adobe Acrobat Reader format. So, be patient if you have a slow internet connection.

<http://www.census.gov/prod/2002/pubs/po102-ma.pdf>
[extracted from Allen County -The Newsletter, June 2002-pg 601]



Abraham Lincoln & Stephen Douglas
Washington Park - Ottawa, IL

Pictured above is the Lincoln-Douglas monument located in Washington Park, in the center of Ottawa. It represents the debate that they had in this park when running for Congress.

Listed below are places to stay while in Ottawa. Additional information on the facilities can be obtained at the Ottawa Visitors Center, at 100 W. Lafayette St., in the Old Reddick Mansion. The Center's phone number is (815) 434-2737 or (888) 688-2924.

The web site: www.visit-ottawa-il.com

Ottawa Hotel Properties and B&Bs

Comfort Inn: 510 East Etna Road, phone (815) 433-9600, (800) 228-5150.

Holiday Inn Express: 120 West Stevenson Road, phone (815) 433-0029, (800) HOLIDAY

Ottawa Travelodge: I-80 & Route 23, phone (815) 434-3400

Hampton Inn: 4115 Holiday Lane, phone (815) 434-6040, fax (815) 434-6045

Sand's Motel: 1215 LaSalle St., phone (815) 434-6440

Super 8: 500 Etna Road, phone (815) 434-2888, (800) 800-8000

Surrey Motel: Route 23, phone (815) 433-1263

Prairie Rivers Bed & Breakfast: 121 E. Prospect Ave., phone (815) 434-3226

Marcia's Bed & Breakfast: 3003 N. Route 71, phone (815) 434-5217

List of Grand and Petit Jurors for the March Term of the LaSalle Circuit Court March 21, 1845

Grand Jurors

George A. Southworth	Russell Bliss
Joseph Russell	Thomas Wakeham
Joseph Stockham	Wilie Moffit
Nathan Townsend	Isaiah Strawn
Edward C. Hall	John S. Simpson
C. M. Van Doren	William G. Worsley
William McCormick	William Richardson
Charles Preston	William M. ____?
John Gibson	Daniel Eichelberger
Thomas B. Elliott	J. S. Bullock
I. D. Harmon	Livingston Jenks
Daniel De Graff	

Petit Jurors

First Week	Second Week
Jesse Pugsley	Samuel Lesler
David P. Strout	E. W. Whiting
Samuel Carter	H. Beardsley
Levi Carter	David Springstead
Lawrence Hoffman	S. W. Sampson
William Kelly	B. T. Roads
William Simmons	Harvey Shaver
G. Searls	Norton Mackey
F. Foaley	Joshua Curtis
Gideon Mace	Asa Baldwin
Daniel Collins	H. S. Beebe
John S. Mitchell	E. M. Moore
George Sawyer	Henry Glover
John Trout	James Wood
Alfred F. Thompson	James F. Hall
Joseph Mason	John Kim
Jacob Whitehead	Bradford Eels
J. Mansfield	Oliver J. Gibbs
Charles Beal	B. H. Briggs
Alanson Beebe	Marshall Miller
S. M. Gum	James O'Conner
John E. Baker	Loring Delano
Solomon Brock	Henry Angell
James Painter	David Gibson

[Ottawa newspaper-March 21, 1845]

A Bright Child

"Father, I do wish you would send for the doctor."
 "Why so, my child, are you sick?"
 "No, I ain't exactly sick."
 "Then why do you want the doctor?"
 "Cause, I want he should come and fell of my pulse,
 and tell me whether I am tired or lazy!"

Ottawa newspaper-April 13, 1842]

IL
LA 5
1.3**Early LaSalle County Marriages**

The following marriages include only ones that were not found in the index of marriages held by the office of the County Clerk, LaSalle County, IL. These marriages were extracted in 1994 from the original church records of St. Patrick's Parish, LaSalle, IL. On many of these marriage records, the names of the parents for both bride and groom were recorded, information not included here. St. Patrick's Parish was established in 1838 and was the one and only church to serve Catholics between Chicago and St. Louis for a number of years. It was first known as the Church of the Most Holy Cross until 1851 when the name was changed to St. Patrick's.

The church was staffed by the Vincentian order of missionary priests who traveled as far as 120 miles southwest of LaSalle to administer the sacraments to Catholics scattered in settlements along the Illinois River who lived in Pekin, Lacon, Peoria, Hennepin, Henry, Kickapoo, etc. The locality where the marriage took place is named in but a few instances in the church records. The following list includes the name of the bride and groom, the date of the marriage followed by the name of the priest who performed the ceremony, also the town where performed.

This information was extracted from the church records by Mary Zukowski.

SPILLANE, Jeremiah

CAVANAGH, Ludovica, 17 April 1838, John B. Raho, Priest

CORIGAN, Patrick

RYAN, Anna, 24 May 1840, John B. Raho, Priest

MC CUM, Michael

LAULLIES, Maria, 31 July 1840, John B. Raho, Priest

EGAN, John

CLARK, Maria, 28 February 1840, John B. Raho, at Peoria

HOES, John

ROSEMBERG, Maria Anna, 11 Oct 1840, John B. Raho
at Black Partridge (now known as Lourdes)

WOODS, Orlando Hutton

MALLIARD, Heloisam Teresa Amenda, 21 Oct 1844,
Aloysius Parodi, Priest, at Woodville

MAGRATH, Edward

VADENBURG, Charlotte, 10 Nov 1844, Aloysius Parodi,
Priest, at Dixon

REVE, Henry

FISHER, Anna Catherine, 28 Nov 1844, Aloysius Parodi

MATTHEYSON, John

KINEY, Brigetta, 15 Aug 1845, Alphonse Montuori, Priest

HIELD, Conrad

FRAISE, Appollonia, 23 Nov 1845, Aloysius Parodi, Priest

SLOWEY, Bernard

GRADY, Anna, 25 Jan 1846, Alphonse Montuori, Priest

LEEHY, Jacob

SEARS, Margarita, 22 March 1846, Alphonse Montuori

RYAN, Jacob

KINGSTON, Maria, 5 April 1847, Alphonse Montuori

JOHNSON, Walter

HALLIGAN, Esther, 1 October 1848, Fr. Mark Anthony

FRANCIS, John

BULGER, Maria, 1 October 1848, Fr. Mark Anthony

CHANCE, John

PALING, Catharine, 28 Dec 1848, Fr. Alphonse Montuori

COOK, Eugene

CASSIDY, Margarita, 7 Jan 1849, Fr. John O'Reilley

O'DONNELL, John

O'CONNELL, Helena, 29 Apr 1849, Fr. John O'Reilley

PAUPER, Francis

GRAHUSE, Maria, 13 May 1849, Fr. Alphonse Montuori

QUINN, Thomas

HOY, Maria, 23 May 1849, Fr. Alphonse Montuori

BRANDENBARK, Anton

HUSS, Catherine, 2 June 1849, Fr. Alphonse Montuori

GAYNER, John

KENEDY, Catharine, 12 Oct 1849, Fr. Alphonse Montuori

LUTZ, Anton

HARTZ, Eva, 30 Sept 1849, Fr. Alphonse Montuori

HOBBS, Joseph

HANDROCHY, Alexandra, 6 April 1850,
Fr. Alphonse Montuori

O'BRIEN, Michael

CLANCY, Anna, 4 May 1850, Fr. Alphonse Montuori

HENAPHIN, Daniel

LYONS, Helen, 9 June 1850, Fr. Alphonse Montuori

WRIGHT, Richard

FONT, Maria D., 16 June 1850, Fr. John O'Reilley

[To be continued in May/June newsletter]



Grandma and the Family Tree

There's been a change in Grandma; we've noticed her of late,
 She's always reading history or jotting down some date.
 She's tracking back the family; we'll all have pedigrees.
 Oh, Grandma's got a hobby; she's climbing Family Trees.

Poor Grandpa does the cooking now, or so he states,
 The worst of all, he has to wash the cups and dinner plates.
 Grandma can't be bothered; she's busy as a bee
 Compiling genealogy — for the Family Trees.

She has no time to baby-sit; the curtains are a fright,
 No buttons left on Granddad's shirt, the flowerbed's a sight.
 She's given up her club work, the serials on TV,
 The only thing she does nowadays is climb the Family Tree.

She goes down to the courthouse and studies ancient lore,
 We know more about our forebears than we ever knew before.
 The books are old and dusty; they make poor Grandma sneeze,
 A minor irritation when you're climbing Family Trees.

The mail is all for Grandma, it comes from near and far,
 Last week she got the proof she needs to join the DAR.
 A worth while avocation, to that we all agree,
 A monumental project, to climb the Family Tree.

Now some folks came from Scotland and some from Galway Bay,
 Some were French as pastry, some German all the way.
 Some went on west to stake their claim, some stayed near by the sea.
 Grandma hopes to find them all as she climbs the Family Tree.

She wanders through the graveyards in search of date or name,
 The rich, the poor, the in-between, all sleeping there the same.
 She pauses now and then to rest, fanned by a gentle breeze
 That blows above the Fathers of all our Family Trees.

There were pioneers and patriots mixed in our kith and kin,
 Who blazed the paths of wilderness and fought through thick and
 thin,
 But none more staunch than Grandma, whose eyes light up with
 glee
 Each time she finds a missing branch for the Family Tree.

Their skills were wide and varied, from carpenter to cook
 And one (Alas!) the records shows was hopelessly a crook.
 Blacksmith, weaver, farmer, judge, some tutored for a fee,
 Long lost in time, now all recorded on the Family Tree.

To some it's just a hobby, to Grandma it's much more,
 She knows the joys and heartaches of those who went before.
 They loved, they lost, they laughed, and they wept, and now
 lay forever still,
 But they will not be forgotten as long as Grandma climbs the
 Family Tree.

[Author unknown]

Gladfelter Funeral Home-Ottawa, IL

Index of Funerals

1865

Jan 1	Mrs. Belknaps
Jan 11	A. Fish
Mar 7	O. L. Werde
Mar 12	James Reed
Mar 14	Mrs. Doc Hathaway
Mar 27	C. E. Bradford
Mar 27	Mrs. Wm Farmhall
Apr 6	L. Johns
Apr 17	Doc Putman
Apr 21	Mr. Trumbo
Apr 21	G. B. Mitchell
Apr 22	Wm Formhuls
Apr 27	Mr. Bodwell
Apr 28	Allen child
May 10	Mr. Witman
May 11	Mr. Weyerbuck
May 18	C. B. King
May 23	M. H. Swift
May 27	Goffin
May 28	Cox
May 29	Trumbo
Jun 11	Vanclosen
Jun 30	J. W. Hagerty
Jul 3	Col J. Morrel niece
Jul 3	J. Rope
Jul 7	Doc Higby mother
Jul 15	Chas Wideman
Jul 17	Wm H. H. Hurton
Jul 17	Mr. Tuttle
Jul 20	Fifemein child
Jul 22	L. Mallory
Jul 23	Wm. H. H. Hutton
Aug 1	J. W. Morrison
Aug 1	C. M. Van Dorren
Aug 2	Chas Roades
Aug 8	S. Neff
Aug 9	Mr. Hamilton
Aug 10	F. Hill
Aug 11	Col J. Morrel wife
Aug 14	Jack
Aug 19	J. A. V. Hose
Aug 19	F. B. Gridley
Aug 20	Newman
Aug 25	Mrs. Murry
Sep 10	Marvin Dimmick
Sep 25	C. Stout
Oct 9	N. Poundstone
Oct 9	F. Gibson
Oct 10	John Maharty
Oct 18	Mr. Good
Oct 23	L. Lightfoot
Oct 30	R. Clark

(Continued on page 9)

Gladfelter Funeral Home
1865

Nov 2	Chas Delano
Nov 3	Mr Phelps
Nov 4	Wm Pearson
Nov 6	J. Griffeth
Dec 2	Geo Crane
Dec 9	Mr Duplain
Dec 10	R. P. Harding
Dec 27	Dr. Closen
Dec 27	Mr. Whycoff
Dec 30	J. Leland son
Dec 31	Johns

999999999999999999999999999999999999

Modern day embalming first came to America during the Civil War. One doctor in Washington, D. C. embalmed more than 4,000 soldiers at \$100 each. These embalmers would follow the armies and when they came upon a body, they would search it for letters. If they could identify family connections they would wrap the body tightly, bury it in a shallow grave and wire for instructions.

(Twigs & Branches, Dec. 1996)

At the wedding of the latter, her sisters, with their husbands, were present. After the ceremonies of the wedding were over the old gentleman said to the guests: "I have taken great pains to educate my daughters, that they might act well their parts in life; and from their advantages and improvements I fondly hoped that they would do honor to their family; and now I find that all my pains, cares, and expectations, have turned out nothing but a Poor, Little, Short, Brown, Hog."



A Happy Easter To All Of You

(SCG Society, June 1998, Vol. 15, No 4)

Early LaSalle County Marriages

The following marriages include only those that were not found in the index of marriages held by the office of the County Clerk, LaSalle Co., IL. These marriages were extracted in 1994, by Mary Zukowski, from the original church records of St. Patrick's Parish in LaSalle.

(continued from May-June 2003 newsletter)

HAVERTY, Thomas

BERRY, Brigid, 29 October 1851, Fr. John O'Reilley

SHEHAN, David

DEXTER, Mary Ann, 2 November 1851, Fr. John O'Reilley

KANE, Jacob

MANNING, Anna, 2 November 1851, Fr. John O'Reilley

COLEMAN, Michael

DOWNEY, Elizabeth, 8 November 1851, Fr. John Quigley

BURNS, Thomas

BEAUBIEN, Mary, 19 November 1851, Fr. John Quigley

LOWER, Andrew

SHOUPPEL, Catherine, 27 December 1851, Fr. John Quigley

FORD, Jack

CONNELLY, Mary, 11 January 1852, Fr. John Quigley

MEISENBACH, Francis

RECK, Helen, 27 January 1852, Fr. John O'Reilley

ZAPP, Edward

RECK, Elizabeth, 6 February 1852, Fr. John O'Reilley

MURPHY, Jeremiah

TOOLE, Anna, 7 March 1852, Fr. John O'Reilley

MORAN, John

GALLAGHER, (Mrs) Anna, 20 March 1852, Fr. J. O'Reilley

DAILY, Daniel (from Dixon)

SMITH, Catherine, 25 March 1852, Fr. John O'Reilley

McENANEY, Michael

CUNNINGHAM, Margaret, 30 March 1852, Fr. J. Quigley

BAKER, Thomas

DUNNE, Anne, 18 April 1852, Fr. John Quigley

BARRETT, John

O'BRIEN, Anna, 20 April 1852, Fr. John Quigley

DUFFY, Hugo (from Dixon)

HAMILL, Isabell, 21 April 1852, Fr. John O'Reilley

MAY, Joseph

STEIN, Mary, 26 April 1852, Fr. N. Stehle

KAMPER, Christian

KEIHLIE, Maria, 3 May 1852, Fr. John Quigley

HEUTER, Jacob (from Henry)

WEBBER, Josephine, 3 May 1852, Fr. N. Stehle

KIRK, Eugene

McANY, Catherine, 6 May 1852, Fr. John O'Reilley

WOODS, Daniel

MARTIN, Mary, 16 May 1852, Fr. John Quigley

THEISS, John

LAHR, Philippina, 20 May 1852, Fr. N. Stehle

BECKER, Mathias

LAHR, Elisabeth, 20 May 1852, Fr. N. Stehle

LEE, Daniel

GLENNON, Catherine, 30 May 1852, Fr. John Quigley

MYNEHAN, Bartholomew

FINTY, Margaret, 6 June 1852, Fr. John Quigley

KENNY, Patrick

TOLLET, Bridget, 10 June 1852, Fr. N. Stehle

HORRIGAN, Thomas

DEGAN, Helen, 18 July 1852, Fr. John O'Reilley

MATTERN, Francis

(no bride listed), 23 July 1852, Fr. N. Stehle

HURLEHEY, Daniel

McCARTHY, Margaret, 12 Sept. 1852, Fr. John Quigley

HAYS, Lawrence

PRENDERGAST, Brigid, 12 Sept 1852, Fr. J. O'Reilley

BLACKMORE, Henry

WALL, Mary, 12 Sept 1852, Fr. John O'Reilley

RAWSON, Edward

MONAHON, Mary, 3 October 1852, Fr. John O'Reilley

McDONAGH, Jjoseph

KEENAN, Bridget, 10 October 1852, Fr. John Quigley

CORRIGAN, Patrick

REILLY, Mary, 17 October 1852, Fr. John Quigley

[to be continued in next newsletter]

TROY GROVE TOWNSHIP

The Township of Troy Grove is congressional district 35 north, range 1 east. It gets its name from a fine tract of timber called by that name, which lies mostly within its limits. It is bound on the north by Mendota Twp., on the east by Ophir Twp., on the south by Dimmick Twp. and on the west by Bureau County. The Little Vermillion runs through it from north to south, near the eastern side and through the center of the grove and furnishes mill power. The grove was named by Warren Root, one of the first settlers, who came from Troy, New York. [This grove is shown on the 1870 map] There are about three sections of land in this township, the rest is prairie of good quality. Trenton limestone crops up along the banks of the Little Vermillion, on sections 25 and 35. This furnishes a very good building stone, it is extensively quarried and of great value to the rest of the county. The Trenton limestone at this point is remarkably rich in fossils, which makes of much interest to geologist.

Troy Grove was organized as a township in accordance with an act of the General Assembly dated Feb. 12, 1849, the first meeting was held April 2, 1850. The first officers chosen were: 1850— Supervisor, P.J. Wagner; Clerk, Wm. Wooster; Assessor, John Farquharson; Collector, M.D. Masterman; Justices, Levi Kelsey and O.A. Andrews; Constables, John S. Simpson and Wm. W. Mc Laughlin. New officers were chosen each year.

The population of the Township in 1870 was 1,051 with 434 being foreign born. In 1880 the census showed 1,407, 88 in the edge of Mendota [City] and 168 in Homer Village. [part of section 4 is in the City of Mendota] The population in 1960 was 271 in Troy Grove. [Homer]

Homer was one of the earliest villages in this part of the county. It was laid out by Kirtland and Colton in 1836. They purchased the land from R.H. Wixom who had settled there the year before. Colton was from Homer, New York and named the village for his native place. William A. Hickok, father of James B., "Wild Bill", opened the first store in the town, here in a crude dwelling his famous son was born. The nearest town was Peru, which for many years was the public market. Mr. Hickok was followed in business by James Newton Reeder, Justin D. Wixom and John Johnston. The P.O. at Homer was established March 21, 1837, because there was already a P.O. named Homer, in the state, the P.O. would not allow Homer, so they called the P.O. Troy Grove. Changed to Troygrove January 18, 1896. Changed to Troy Grove since 1931. In the spring of 1884 they talked of incorporation, but the population was 200, - 300 was required by law, so it was abandoned. Many of the voters too were opposed.

The earliest settler in Troy Grove Township was Elias Carey, who located on section 24 in February, 1831. The next May, Hiram Thornton joined him, these two being the only residents at the opening of the Black Hawk War. They fled to Fort Wilburn, opposite La Salle, they remained there for two weeks. While there Mrs. Cary gave birth to a son, George W. who though not born in the actual limits may claim to be the first white child born here. He still lives in Homer [1877]. A Mr. Kelse had a cabin a short distance from

1870 Troy Grove Map



[Source 1876 Atlas and 1870 Map of La Salle County]

ORANGE COUNTY CALIFORNIA
GENEALOGICAL SOCIETY

Homer, here he opened a store before the village was laid out. He continued running it for some time. In 1835-1836 a sawmill was erected by several of the settlers for their use. It was purchased by Reeder and Wixom. They sawed the lumber for the school built in 1837 at a cost of \$205.00. Until Mendota was established all the trade from this locality came to this town, and made a good business. Three or four stores were well supported and an equal number of shops. Trade was going well until Mendota was started. After that business went down hill and the area remained small. The only railroad in the township in 1886 was the Illinois Central, it was one and a half miles from Homer, the nearest station, Dimmick was three miles. The Northern Illinois Railroad [a branch of the Northwestern] is now [1886] constructing a line through the township, which will pass through the village. The town of Troy Grove is still there. They have a large sand and gravel business which takes up much of the township.

CHURCHES

The Presbyterian Church was organized in 1849. With these eight members James and Mrs. Smith, A. Hoffman and wife, Mrs. Chapin, Mr. Nye, and P.L. Porter. The organization took place at Batchelor Ridge about four miles east of Homer, in a school house. The presiding minister was Rev. James S. Baldwin. The same year they built a church there. In 1850 they erected one in Homer. In 1877 they had fifty members. Some of the early members were W. K. Dewey, Ansel Dewey and Alonzo Hickok. There was a Frame church built in 1867 at a cost of \$1,600.

The Free Will Baptist church was organized in the Presbyterian church in 1860, with about fifty members. The Baptist society was organized by Elder Cyrus Coltrin, who settled here nearly thirty years ago. First members were Mrs. Mary M. Firestine, Mrs. Priscilla Reeder, Mrs. Elmira Mitten, Mrs. Mary J. Gibbs, Mrs. Bethia Welsh, Dr. R.B. Mahannah, Cordelia A. Mahannah, John Dash and wife, John Peters and wife, William Brown and wife Pamela, John Killing, Ceph. Higgins, and others. Sunday school meets regularly with fifty to sixty in attendance.

The Methodist had a minister here, Rev Foreman for some years. A class was formed by John Johnson and son, George W., John Simpson, W.K. Dewey, Jesse Wixom and others. Stephen McPherson and William Maddox were prominent members.

In the western part of the township were three churches, Catholic Church, Fair View Church and Troy Grove Lutheran; Catholic Church ; [St. Peter Paul of Peterstown] Catholic settlers were visited occasionally by a priest from Mendota. By 1851 these visits were made once a month, by Father Kremer coming from La Salle. In 1853 they bought four acres of land for a church, school, cemetery etc. The first church was erected that year. Until 1865 this church was visited by a priest from Aurora, then it was annexed to Mendota. In 1872-73 the present stone church was built. The school house was built in 1865 and a parsonage in 1874-75. This was destroyed by fire in 1876 and rebuilt two years later. The present pastor[1886] Rev P.L. Heider came in 1885. The school is taught by Franciscan Sisters from La Crosse, Wi. The Congregation is entirely debt free.

Fair View Church: Belonging to the United Brethren organization located on section 29 in the township, was built in 1858, under the supervision of Jonas Eckel. Rev. W.N. Baker was the pastor in charge in 1885. The church has a membership of thirty. Among the pastors in the past were Revs. C. Wendell, G. Snyder, J.L. Harrison, Miles and Joseph Lewis, H. Eby, J. Beghtel, W.H. Post and W.H. Chandler. In the early days services were in German. Rev. J. E. Sheffer, in 1861 was the first English preacher.

Troy Grove Lutheran Church: is located in the southwest corner of section 29. A small wooden structure with no bell but big enough for their needs. It was built in 1862, at a cost of \$700, under Rev. Henry Leitman of Peru, who for a short time supplied its pulpit every two weeks. Services have been held on alternate Sabbaths since. They have never had a resident pastor. In 1885, the pulpit was supplied by a pastor from Mendota.

[source History of La Salle County 1886]

TROY GROVE CITY PARK MEMORIAL

IN MEMORY OF "OUR HEROES" BURIED IN UNKNOWN GRAVES

William Petts

L. W. Clark

H. S. Dunlap

F. M. Maddox

D. M. Harris

Addis Lynn

A. J. Gilbert

Thomas Newell

Alex Murray

Charles Meinhart

John Scheutz

D. C. Ryneearson

Michael Miller

James Fitzsimmons

ORANGE COUNTY CALIFORNIA
GENEALOGICAL SOCIETY

(Done by Betty Frye & Leona McCullough)

Old Settlers of LaSalle County**E through L some M's**

A continuation taken from the records in the possession of the Secretary, A.M. Ebersol.

Eichelberger, F.C., P. O. Ottawa, born York Co., Pa., settled here 1837
 Ebersol, A.M., P.O. Ottawa, born Harrisburg, Pa., settled here Aug. 1834
 Ebersol, D.S., P.O. Ottawa, born Harrisburg, Pa., settled here Aug. 1834
 Ebersol, A.H., P.O. Ottawa, born Harrisburg, Pa., settled here Aug 1834
 Ebersol, Joseph, P.O. Ottawa, born Harrisburg, Pa., settled here Aug. 1834, died January 13th 1873
 Ebersol, Jas. E.C., P.O. Strawn, born LaSalle Co. 1845
 Ebersol C. Whittlesey, P.O. Ottawa, born New Britain, Conn., settled here 1842
 Ebersol, Elizabeth S., P.O. Ottawa, born Lower Paxton, Pa., settled here 1834, died Feb. 26th, 1871
 Edgecomb, R.E., P.O. Ottawa, born New York, settled here Oct., 1835
 Ebersol, M. Jane, P.O. Ottawa, born Maysville, Ky., settled here 1840
 Eaton, Seth, P.O. Lowell, born Middleborough, Mass., settled here 1834
 Eaton, Maria C.B., P.O. Lowell, born Pa., settled here 1832
 Esmond, C.W., P.O. Ottawa, born Saratoga, N.Y., settled here 1845
 Esmond, Anna E., P.O. Ottawa, born Indiana, settled here 1854
 Foster, Amasa, P.O. Ottawa, born Ottawa, April 1837
 Fenton, W.M., P.O. Ottawa, born Columbus, Texas, settled here July, 1836
 Fredenburg, Henry, born Ottawa, March, 1836, killed 1870
 Fredenburg, I.H., P.O. Utica, born New York, settled here June, 1834
 Fisher, Abner A., P.O. Ottawa, born Rochester, N.Y., settled here 1840
 Fife, George, P.O. Ottawa, born Glasgow, Scotland, settled here 1849
 Farrell, Alice W., P.O. Ottawa, born Floral Home, LaSalle Co., Ill., 1847
 Green, Jesse, P.O. Dayton, born Ohio, settled here 1829
 Green, David, P.O. Dayton, born Ohio, settled here 1829
 Green, John, P.O. Dayton, born Ohio, settled here 1829

Green, Chas. H., P.O. Ottawa, born Chesterfield, N.H., settled here 1833
 Glover, Jos. O., born Penn Yan, N.Y., settled here 1835, removed to Chicago.
 Goodell, R. Eaton, born Pomfret, Conn., settled here 1834, removed to Chicago
 Gridley, Henry W., P.O. Ottawa, born Mass., settled here 1835
 Gibson, John, born Newark, Ohio, settled here 1839, died Aug. 2d, 1872
 Gentelman, Wm., P.O. Ottawa, born Orange, N.Y., settled here Jan. 1834
 Gartman, Wm., P.O. Ottawa, born York Co., Pa., settled here 1837
 Gridley, Samuel W., born Rehoboth, Mass., settled here 1834, died March 28th 1876
 Green, Alma, born Chesterfield, N.H., settled here October, 1833, removed
 Gum, Saintclare, P.O. Marseilles, born Rockingham Co., Va., settled here April 1830
 Gibson, Rachel G., P.O. Dayton born Licking Co., Ohio, settled here 1829
 Green, Barbara, P.O. Dayton, born Licking Co., Ohio, settled here December 1829
 Green, Mary S., P.O. Dayton, born Licking Co., O., settled here 1829
 Gunn, Aaron, P.O. LaSalle, born Montague, Mass., settled here 1838
 Galloway, George, P.O. Marseilles, born LaSalle Co. 1828
 Gates, Robt., P.O. Kendall, born Maryland, settled here 1837
 Grove, David, P.O. Ottawa, born LaSalle Co., 1829
 Hickling, Wm., born England, settled here 1834, removed to Chicago.
 Hitt, D.F., P.O. Ottawa, born Bourbon Co., Ky., settled here 1830
 Huston, John, P.O. Ottawa, born Pennsylvania, settled here 1836
 Hubbard, John born Courtland Co., N. Y., settled here 1834, died Dec. 31st, 1875
 Hoffman, John, P.O. Mendota, born Tioga Co., Pa., settled here July 19th, 1838
 Halderman, A.S., P.O. Streator, born Lexington, Ohio, settled here 1830
 Harvy, Polly, born Syracuse, N.Y., settled here 1835, removed to Elgin.
 Holdridge, R.L., P.O. Tonica, born Madison Co., N.Y., settled here '30
 Hupp, Elizabeth M., P.O. Tonica, born Ohio, settled here Nov., 1840
 Hupp, S.W., P.O. Tonica born Newark, Ohio, settled here 1829

Holdridge, Wm., H.H., P.O. Tonica, born Madison Co., N.Y., settled here 1831
Hollister, M.E., born N.Y., settled here 1836, removed to Boise City, Idaho
Hays, Samuel J., P.O. Ottawa, born Litchfield, Conn., settled here November 1833
Hopack, John, P.O. Ottawa, born Canada, settled here March 1838
Hep, Jeremiah, P.O. Utica, born Clermont Co., O., settled here '33
Hartshorn, A.J., P.O. LaSalle, settled here August, 1837
Hoxie, P.W., P.O. Tonica, born Massachusetts, settled here 1840
Holeman, Caroline, P.O. Utica, born Ohio, settled here 1833
Hodgson, Eli, P.O. Ottawa, born Clinton Co., Ohio, settled here '31
Hodgson Phebe, P.O. Ottawa, born Scioto Co., Ohio, settled here 1832
Hadley, Lemuel, P.O. Utica, born Clermont Co., Ohio, settled here 1838, died 1876
Hadley, Ann, P.O. Utica, born Clermont Co., Ohio, settled here 1836
Hawley, Ezra, P.O. Tonica, born Bennington, Vt., settled here 1835
Harris, Justus, P.O. Ottawa, born Genesee Co., N.Y., settled here May, 1842
Hanna, Sophia A., P.O. Ottawa, born LaSalle Co., July, 1837
Hurd, Hiram, P.O. Vermillionville, born Arlington, Vt., settled here 1837
Hurd, Henrietta, P.O. Vermillionville, born Arlington, Vt., settled here 1837
Hays, Sophia W., P.O. Ottawa, born Mass., settled here 1835
Hoxie, Lucinda, P.O. Tonica, born Massachusetts, settled here 1837
Ish, Alexander, P.O. Peru, removed
Jackson, Giles W., P.O. Ottawa, born New York, settled here 1837
Jacobs, P.W., P.O. Ottawa, born Norway, settled here Sept., 1836
Jacobs, Nancy C., P.O. Ottawa
Jackson, Hannah, P.O. Ottawa, born New York, settled here 1836
Jones, W.L.F., P.O. Millington, born Rutland Co., Vt., settled here '37
Kirpatrick, Murray, P.O. Vermillionville, born Ohio, settled here July 1837
Kellogg, Philo, P.O. Prairie Center, born Otsego Co., N.Y., settled here 1837

Lewis, Samuel R., P.O. Ottawa, born Washington Co., Pa., settled here 1833
Lathrop, Dixwell, born Norwich, Conn., settled here 1835
Leland, L., P.O. Ottawa, born Grafton, Mass., settled here July 1835
Leland, Edwin S., P.O. Ottawa, born Roxbury, Mass., settled here 1835
Leland, Margaret B., P.O. Ottawa, born Baltimore, Md., settled here 1835
Lewis, Benjamin, P.O. Freedom, born LaSalle Co 1835
Lockwood, Eugene D., P.O. Peru, born New York, settled here 1840
Lockwood, Susan, P.O. Peru, born settled here 1840
Lockwood, M.B., P.O. Peru, born Rochester, N.Y., settled here '40
Lockwood, Eliza J., P.O. Peru, born Ireland, settled here 1839
Lett, Thomas, P.O. Sandwich, born Texas, settled here 1839
Lett, Marietta, P.O. Sandwich, born New York, settled here 1838
Lewis, Rachel, P.O. Ottawa, born Pennsylvania, settled here 1833, died April 24th 1874.
McLaughlin, Chas., P.O. Troy Grove, born Maine, settled here October, 1835
McLaughlin, Aug., P.O. Troy Grove, born Maine, settled here 1834
McKernan, Mary B., P.O. Streator, born Lexington, Ohio, settled here October, 1831
McKernan, Capt. Jas., P.O. Streator, born Kentucky, settled here 1828
Mudge, Chas., P.O. Tonica, settled here 1840
Mudge, Eunice, P.O. Tonica, settled here 1845
Manley, Maria, P.O. Ottawa, born Onondaga Co., NY., settled here 1842.
Milliken, Rebecca, P.O. Ottawa, born Licking Co., Ohio, settled here September, 1830
Moore, Jane M., born New York, settled here Aug. 24th, 1838, died Jan. 14th, 1876
Munger, Olive, P.O. Ottawa, born LaFayette, Ia., settled here July, 1836
Munson, Wm., P.O. Freedom, born Uniontown, Pa., settled here '30
McCormick, Wm. S., P.O. Ottawa, born New York, settled here '33
Miller, Marshall, P.O. Ottawa, born Vermont, settled here 1833
Manley, John, P.O. Ottawa, born Clinton Co., N.Y., settled here 1837
Moore, Wm. C., P.O. Ottawa, born Pennsylvania, settled here 1835

**DATES WHEN EACH STATE REQUIRED
DEATH AND BIRTH REGISTRATIONS**

STATE	DEATH	BIRTH
Alabama	1908	1908
Alaska	1913	1913
Arizona	1909	1909
Arkansas	1914	1914
California	1901	1901
Colorado	1907	1907
Connecticut	1897	1897
Delaware	1881	1881
Florida	1915	1915
Georgia	1919	1919
Hawaii	1896	1896
Idaho	1911	1911
Illinois	1916	1916
Indiana	1882	1882
Iowa	1880	1880
Kansas	1911	1917
Kentucky	1911	1911
Louisiana	1914	1914
Maine	1892	1892
Maryland	1898	1898
Massachusetts	1841	1842
Michigan	1867	1867
Minnesota	1900	1900
Mississippi	1912	1912
Missouri	1910	1910
Montana	1907	1907
Nebraska	1905	1905
Nevada	1911	1911
New Hampshire	1905	1905
New Jersey	1848	1848
New Mexico	1910	1910
New York	1880	1880
North Carolina	1913	1913
North Dakota	1908	1908
Ohio	1909	1909
Oklahoma	1908	1908
Oregon	1903	1903
Pennsylvania	1906	1906
Rhode Island	1852	1852
South Carolina	1915	1915
South Dakota	1905	1905
Tennessee	1914	1914
Texas	1903	1903
Utah	1905	1905
Vermont	1857	1857
Virginia	1912	1912
Washington	1907	1907
Washington D.C.	1855	1871
West Virginia	1917	1917
Wisconsin	1907	1907
Wyoming	1909	1909

Taken from Among the Coles (Coles County Illinois Genealogical Society's newsletter), Vol. XXVIII, No. 05 & 06, May & June 2002

**KILL HOUSEFLY, WARNING
OF THE HEALTH OFFICERS**

Battle on Disease Spreader Urged at
This Time by Doctors and
Other Authorities

Kill flies now.

This is the most profitable fly hunting season.

Every fly killed now may mean the saving of a human life.

Every fly killed now means the prevention of the birth of 3,000,000 more this summer.

The fly season is here and people must guard against the contamination of food supplies. To repeat, every fly killed may mean a human life saved, for one fly killed at this season of the year, if left to follow the natural course of its life, would have increased its family to the number of about 3,000,000 by the time cold weather came and prevented further reproduction.

To get rid of the fly, one must start at once and the following suggestions given by health authorities will greatly aid the city in the stamping out of this evil.

First, screen houses thoroughly; from basement to attic, every window and door. Keep the flies from gaining entrance now and you will not have any in the summer.

Second, if you have few in the house, spread fly paper or distribute poison drinks around the premises now.

Third, and this is important, SCREEN OUT-HOUSES. That is where the fly is hatched; that is where he feeds on human forces and where he comes from when he goes into homes, scattering filth and germs of typhoid on the food in the kitchen and dining room.

Fourth, get galvanized iron garbage cans which can be kept closed. After the garbage collector has emptied the can, disinfect it, using either carbolineum, crude carbolic acid or chloride of lime. Don't throw garbage in alleys or open places.

Fifth, disinfect outhouses with chloride of lime or copperas.

The LaSalle Daily Tribune, May 19, 1911

I man cares not for his
roots, then how can he
care for his branches.

Doyle M Davis

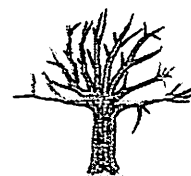

Old Settlers of LaSalle County
some M's through Z

A continuation taken from the records in the possession of the Secretary, A.M. Ebersol.

Mitchell, John S., P.O. Ottawa, born Ontario Co., N.Y., settled here 1837
McPherson, Harvy, P.O. Tonica, born Ripley, Ohio, settled here 1840.
McFarren, J. H., P.O. LaSalle, settled here May, 1837.
Morrison, John, P.O. Tonica, born Scotland, settled here 1851
Morrison, Mary, P.O. Tonica, born Maryland, settled here 1857.
Murray, John P.O. Ottawa, born New Jersey, settled here June 11th, 1840.
Miller, John, P.O. Freedom, born Pennsylvania, settled here 1838.
Neff, Wm. D., P.O. Ottawa, born Indiana, settled here 1835.
Neustadt, Morris, born Germany, settled here 1838, died 1874.
Newerson, Newton, settled here June, 1835.
Ney, Edwin H., born Utica, settled here May 1838.
Newton, Geo., M., P.O. Tonica, born New York, settled here 1835.
Newton, C.S., P.O. Tonica, born LaSalle Co., 1831
Nary, Edward, P.O. Utica, born Ireland, settled here 1848.
Nichol, J.T., P.O. Marseilles, born Washington Co., Pa., settled here June, 1844.
Nichol, Rebecca M., P.O. Marseilles, born Richland Co., Ohio, settled here June 1844.
Olmstead, Colman, born New York, settled here 1835, removed.
Olmstead, J.D., P.O. Ottawa, born New York, settled here October 1839, removed to California.
Olmstead, H.D., P.O. Ottawa, born New York, settled here 1833.
Olmstead, Mrs. E.A., P.O. Ottawa, born New York, settled here 1840.
O'Connor, Michael, P.O. Deer Park, born Ireland, settled here 1835, died May, 1873.
O'Neil, Barney, P.O. Streator, born Harrisburg, Pa., settled here 1840.
O'Donnell, Edmond, P.O. Ottawa, born Ireland, settled here 1847.
O'Donnell, Mary, P.O. Ottawa, born Ireland, settled here 1847.
Osman, Wm., P.O. Ottawa, born Harrisburg, Pa., settled here 1840
Pembrook, David, P.O. Ottawa, born New York, settled here 1825, removed to Macoupin Co.,

Patten, F.J., P.O. Seneca, born New York, settled here April '45.
Plymire, Emily, born Ohio, settled here 1844, removed.
Painter, U.S., P.O. Streator, born LaSalle Co., 1843.
Pembrook, Nancy A., born Ohio, settled here 1838, removed.
Parr, Samuel, born Newark, Ohio, settled here Sept., 1832, died June 18th 1872.
Parr, Sally, P.O. Ottawa, born Newark, Ohio, settled here 1830.
Philips, Thos. J., P.O. Newark, born Lancaster, Pa., settled here 1834.
Powers, L.H., born LaSalle Co., 1834, died May, 1871.
Powers, Jane B., born Detroit, Mich., settled here 1839, removed to Hastings, Neb.
Powell, Rev. Thomas, P.O. Ottawa, born Wales, settled here 1836
Pitzer, Wm., P.O. Ottawa, born Ohio, settled here 1831.
Phelps, B.T., P.O. Ottawa, born Virginia, settled here 1828.
Palmer, Wm., P.O. Ottawa, born New York, settled here 1836.
Pembrook, Jeremiah, P.O. Ottawa, born Illinois, settled here 1825.
Pembrook, Mary, born New York, settled here 1835, removed to Macoupin Co.
Philips, J.T., P.O. Ottawa born Luzern, Pa., settled here 1838
Perley, Nathaniel, born Boston, settled here 1835, removed to Kansas.
Palmer Ransom, P.O. Ottawa born Tioga Co., Pa., settled here 1844.
Pickins, Jas. H., P.O. Ottawa born New Bedford, Mass., settled here June 24th, 1840.
Parr, Adaline, P.O. Marseilles, born Ontario Co., N.Y., settled here '36.
Piergue, J.L., P.O. Ottawa, born France, settled here 1846.
Rugg, Geo., H., P.O. Ottawa, born Lancaster, Mass., settled here June, 1838.
Reed, Capt. H.J., P.O. Ottawa, born Pennsylvanie, settled here 1834
Rockwood, E. E., born Chesterfield, N.H., settled here 1835, removed to Indiana.
Rockwood, L. Otis, P.O. Ottawa, born New Hampshire, settled here 1835.
Reynolds, B.B., P.O. Ottawa, born Lewiston, Pa., settled here 1835
Rice, John B., P.O. Ottawa, born Worcester Co., Mass., settled here 1837
Rugg, Lewis P., born Lancaster, Mass., settled here June, 1838, removed to Pontiac.

Reed, Darius, born Monroe Co., N.Y., settled here 1827, removed to Barton Co., Kan.

Rockwood, Wm., H., P.O. Ottawa, born Chesterfield, N.H., settled here 1835.

Russel, Peter, P.O. Ottawa, born Ireland, settled here 1838.

Rockwood, Sally, P.O. Ottawa, born Chesterfield, N.H., settled here '35

Rood, Daniel L., P.O. Marseilles, born New York.

Rowe, Fear B., P.O. Freedom, born LaSalle Co., December 1839.

Rowe, Alexander, P.O. Norway, born New York City, settled here 1835.

Rawling, A. E., P.O. Sheridan, born Indiana, settled here 1835.

Rood, Levi H., P.O. Sheridan, born Connecticut, settled here 1843, died June 17th, 1875.

Robertson, W.H., P.O. Sheridan, born Indiana, settled here 1832.

Robertson, Martha A., P.O. Sheridan, born Indiana, settled here '33.

Richey, James, P.O. Tonica, born Indiana, settled here 1836.

Richey, Anna H., P.O. Tonica, born Ohio, settled here 1836.

Rockwood, Laura, P.O. Ottawa, born New Hampshire, settled here 1835, died March, 1874.

Roy, Joseph I., P.O. Ottawa, born New Jersey, settled here 1836.

Richy, John M., P.O. Lostant, born Muskingum Co., Ohio, settled here 1837.

Reynolds, Eleanor S., born Pennsylvania, settled here 1835, died February, 1874.

Richey, David, P.O. tonica, born Ohio, settled here 1830.

Richey, M.E., P.O. Tonica, born LaSalle Co., 1846.

Rugg, Susan W., P.O. Ottawa, born Massachusetts, settled here 1838.

Raymond, Samuel, P.O. Ottawa, born Windsor Co., Vermont, settled here June, 1837.

Russell, Caroline, P.O. Ottawa, born Watertown, N.Y., settled here '45.

Swartz, Zephaniah, P.O. Streator, born Bourbon Co., Ky., settled here 1835.

Swartz, Sarah, P.O. Streator, born Kentucky, settled here 1834.

Strawn, David, born Ohio, settled here 1840, died Sept., 1873.

Sinclair, Watson, P.O. Ottawa, born Kentucky, settled here 1835.

Southworth, A.P., P.O. Newark, settled here October, 1838.

Seeley, Frances I., P.O. Vermillionville, settled here 1818.

Skinner, Jos. E., P.O. Ottawa, born Orange Co., N.Y., settled here '40.

Stilson, T.S., P.O. Earlville, born Connecticut, settled here 1839.

Stilson, Sarah T., P.O. Earlville, born Ohio, settled here 1846.

Smith, Sarah R., P.O. Sheridan, born Broome Co., N.Y., settled here '36.

Smith, Wm., P.O. Sheridan, born Broome Co., N.Y., settled here '36.

Sage, M.E., P.O. Ottawa, born Barking Ridge, N.J., settled here '40.

Stevenson, Comfort A., P.O. Bruceville, born Licking Co., Ohio, settled here 1830.

Sampson, Stephen W., P.O. Freedom, born Broome Co., N.Y., settled here 1837.

Squires, Susan W., P.O. Ottawa, born Lancaster, Mass., settled here '38.

Strawn, Isaiah, P.O. Ottawa, born Sandusky, Ohio, settled here 1834.

Strawn, Hopie, P.O. Ottawa, born Franklin Co., Mass., settled here '31.

Sampson, Ruhama S., P.O. Freedom, born Broome Co., N.Y., settled here 1837.

Sutphen, E.D., P.O. Earlville, born Boston, settled here 1834, removed.

Sutphen, Chas. H., born Boston, settled here 1834, dead.

Sampson, Luman S., P.O. Freedom, borne Broome Co., N.Y., settled here 1837.

Spradling, Enoch, P.O. Norway, born Tennessee, settled here 1841.

Slater, Rose Ann, P.O. Streator, born Livingston Co., Ky., settled here 1828.

Shaver, C., P.O. Ottawa, born Ohio, settled here 1830.

Shaver, J.R., P.O. Ottawa, born Newark, Ohio, settled here 1830.

Shaver, Harvey, born Licking Co., O., settled ehre 1829, removed to Missouri.

Smith, Frederick, P.O. Ottawa, settled here 1834.

Strawn, Jeremiah, P.O. Ottawa, born Ohio, settled here 1828.

Smith, Alva O., P.O. Serena, born Connecticut, settled here 1834.

Strawn, Abner, P.O. Ottawa, born Sandusky, O., settled here 1834.

Strawn, Eli, P.O. Ottawa, born Ohio, settled here 1837, removed.

Shaw, J.E., born New York, settled ehre 1827, died August 1875.

Skinner, Robt. E., P.O. Ottawa, born LaSalle Co., 1833

Sapp, F.M., P.O. Ottawa, born Bureau Co., Ill, settled here 1848..

True, Geo. A., P.O. Utica, born Boston, settled here Sept., 1838.

Tilden, John P., P.O. Peru, born Massachusetts, settled here 1837.

Tilden, Nancy S., P.O. Peru, born Maine, settled here 1839.

Tanner, Maria P., P.O. Grand Ridge, born LaSalle Co., 1839.

Thatcher, Enos, born New York, settled here 1835, removed to Blackstone, Ill.

Thomas, Esther, P.O. Ottawa, born Franklin, N.Y., settled here Dec., 1834.

Trumbo, Matthias, born Virginia, settled here 1830, died November 1875.

Taylor, Elizabeth S., P.O. Streator, born New Britain, Conn., settled here 1838.

Trumbo, Ambrose, P.O. Ottawa, born Licking Co., O., settled here '30.

Thompson, G.L., P.O. Ottawa, born New York, settled here 1830.

Vandoren, C.M., P.O. Ottawa, born New York, settled here 1837, removed to Washington Ter.

Whitmore, W.F., P.O. Ottawa settled here 1838.

Wood, Jeremiah, P.O. Ottawa, born New York, settled here 1837.

Wilson, Isaac, P.O. Ottawa, born Kentucky, settled here 1834.

Wakefield, Otis O., P.O. Ottawa, born Lewis Co., N.Y., settled here '39.

Watts, Philip C., P.O. Ottawa, born England, settled here 1839.

Wallace, _____, P.O. Earlville, settled here 1837.

Wafer, James, P.O. Ottawa, born Ireland, settled here 1836.

Wafer, Mary, P.O. Ottawa born Ireland, settled here 1836

Warren, Nathan, P.O. Ottawa, born Maine, settled here 1836.

Warren W., P.O. Freedom, born New York, settled here 1836

Warren, Maria W., P.O. Freedom, born Massachusetts, settled here 1836.

Wood, James W., P.O. Vermillionville, born Montgomery Co., N.Y., settled here 1833.

Wood Rebecca, P.O. Vermillionville, born Cattaraugus Co., N.Y., settled here 1841.

Wallbridge, Alonzo, P.O. Marseilles, born St. Lawrence Co., N.Y., settled here 1836, died Feb. 1875.

Warren, Eliza, P.O. Freedom, born New York, settled here June, '34.

Wiswall, Jason, born Norton, Mass., settled here 1835, died Feb. 1875.

Whiting, Jabez, ville, born Connecticut, settled here 1837, removed to Iowa.

Yeager, Joseph, P.O. Wedron, born Indiana, settler here 1842

ONLY FORTY-FIVE DOGS IN LASALLE

That's What Records at the Court House Show—

Do Figures Lie?

Watches and Clocks Scarce

The LaSalle Daily Tribune, Monday, July 24, 1911

Hundreds of Families in LaSalle Must be Without Time Pieces, if Figures Are Believed—Some Amusing Things Are Shown

Watches, clocks, pianos and dogs form a queer combination, but their scarcity in the big county of LaSalle is worthy of at least a few words of comment. According to the assessors' books there are in this county 6,666 watches and clocks, 3,041 pianos and 3,774 dogs. And we are told that figures don't lie!

Ottawa people evidently have an erroneous impression that that city is overrun with dogs. Ottawa in fact is really a "dogless" town, as there are only 55 canines of all ages and breeds in the entire township. Sometimes people are led to believe that there are that many in one block, but it must all be imagination. The extermination of dogs, however, has reached the point of perfection in LaSalle where there are only 45 curs of all descriptions, according to the assessor's books. This is the smallest number of dogs reported from any town in the entire county. Manlius takes the prize for having the most dogs, 207 being reported from that township.

Every resident of LaSalle feels certain that there are at least 45,000 dogs in this city alone, but the figures say, 45 for the township and you know figures do not lie.

There are nearly as many pianos in the county as there are dogs. The people of Bruce are evidently the most musical in the county, 379 pianos being reported there on the assessor's books. The peculiar thing about Bruce is that there are three times as many pianos in the town as there are dogs. This is indeed— a peculiar condition of affairs, but it must be accepted as being the case.

One of the most amazing things which these statistics reveal however, is the fact that the 90,000 people of LaSalle county only possess 6,666 watches and clocks. How in the world they keep track of the time is a mystery as there are thousands and thousands of homes without a single time-piece being possessed by any member of the family. LaSalle only has 141 watches and clocks, less than half as many as there are pianos in this town. This is also a peculiar state of affairs. Rutland is the banner watch and clock town in the county, having 532 time-pieces. Dayton only has 17 and Troy Grove 33. No wonder the residents of those two towns are so slow. Ottawa has 409 watches and clocks, but as there are no alarms to them the county seat still slumbers on. The table of statistics for watches, clocks,

FOR REFERENCE ONLY



MERIDEN TOWNSHIP

Meriden is a congressional township, 36 north, range 2 east, and is bounded on the north by Lee County, on the east by Earl Township, on the south by Ophir and on the west by Mendota. It is almost entirely all prairie, the only timber being the Four Mile Grove on sections 5 and 6. The first settlers came to the grove in 1836, where there was wood for building and fuel, water and plenty of game. There is still a grove of oak bordering the creek. The first settlers were John Haight from near Peru, David Heck and Lyman Alger from Albany County, N.Y.; O.W. Bryant came from Maine to Peru in 1837 to Meriden in 1842; Benjamin Furman and George Wilkinson came from Tioga County, PA, in 1838; Benjamin Birdsall came from the Empire State in 1839; E. R. Hicks and Ira Bailey came in 1848; and David Holden in 1849; other pioneers were John Rose, James Cunningham, Hiram Cristler, John Wisner and Thomas Eager.

There is only one small town in Meriden Township. It is on the C., B., & Q. R.R., about five miles north east of Mendota. It was laid out by John Grey, county supervisor, for Samuel Wiley, May 4th, 1863. A Mr. Jones erected a warehouse that year and dealt in grain. The town is too close to Mendota for any growth. All trade of any value goes to that city. There are a few small shops of various kinds, which find their trade confined to immediate locality. At first the town was called Jobs Station. The Post Office was established Feb. 16, 1863. The receiver of a letter had to pay 14 cents to get his letter from the post office. The sender did not have to pay at all.

This grove also figured in the township and county's early history when it was the home of a band of desperadoes, who stole and murdered at will. The bands were at their height in 1837. They were called "Bandits of the Prairie". The outlaws would steal horses and drive them [at night] to the Illinois River where they would sell them for gold. The horses were loaded on flatboats and sold at far away markets. During the Civil War many horses were taken to the Union Army. In June 1862 good horses were sold to the cavalry for \$100. In 1865 horses for heavy artillery were bringing \$150 to \$200. The great need for animals in the war caused the buyers to overlook the origin. In early times vigilante groups would form posses to control criminals and there were many hangings. The lawmen from Ottawa eventually put the outlaws out of business. There was quite a shooting match before they were ousted from the grove.

When law and order came to the area there came a market for land. The grass was as high as a man on a horse. To break the sod was a real challenge. At first the land sold for \$1.75 per acre, 12cents down. The demand was not that great and it was soon lowered to \$1.25 per acre. Much of the land was sold by the Illinois Central Railroad. They had received a very wide right-of-way from the government, that not used for the railroad was sold. This was sold to help finance the building of the railroad. The railroad was built in 1853. Before it came the farmers from Troy Grove and Meriden, formed caravans and took their crops to Chicago markets. Corn sold for 20 cents a bushel; oats sold for 8.

[source 1877 Past & Present of La Salle Co. - 1886 History of La Salle County, La Salle County Lore, Illinois Place Names]

MERIDEN TOWNSHIP - 1877

- Aldrich Geo. L.**, farmer: sec.16
Aldrich Samuel, laborer
Aldrich Wm., rents farm
Aldrich Chas., farmer, sec. 16;
 Born in Bariston, Mass., Nov. 9, 1815,
 came to this County 1857; First wife Polly
 M. Nichalds, born New York State;
 second wife Isabel Prester, born Potter,
 Yates Co., N.Y., May 27, 1815; M. Jan 6,
 1839; 10 children; Polly M., b. Nov 5,
 1838; Benson, Jan. 25, 1841 [died May 4,
 1863]; Hannah J., Feb. 27, 1843;
 Lucinda, Nov. 25, 1844; Louis Y, July
 29, 1846; David A., Feb. 25, 1849 [died
 June 16, 1872]; Wm. M., Feb --, 1852;
 Mary, Jan. 22, 1854; Amelia, April 27,
 1856; George L., March 3, 1857.
Allard A., farmer; sec 23; born in VT,
 1833; came to Co. in 1856; mar.
 Elizabeth Nean 1860; she was born PA; 1
 child Anna Belle;
Anderson Osman, farmer;
Arnold Grove, farmer; sec. 1;
Austin A., farmer; sec. 10;
Austin Geo. W., lives with father; sec.
 10;
Austin P.J., rents farm;

Ballard Chas., rents farm;
Ballard Fred, rents farm;
Ballard J.J., farmer;
Barton Eleazar, blacksmith and wagon
 maker,
Barton Sylvester, blacksmith;
Beal J.M., farmer; sec. 27;
Beardsley Cicero, laborer;
Beitsch Aug., farm; sec. 34;
Beitsch Chas., Farmer; sec. 34; born in
 Prussia, 1833; came to this Co. May 16,
 1860; mar. Henrietta Schultz in 1864; she
 died 1875; 5 children, Sarah, Matilda,
 Miena, Emma and Alfred;
Bell A.J., farmer;
Bender J.G., farm; sec.10;
Boltz Geo., farmer; sec.24;
Bowen D. W., farmer; sec. 35;

Bowen Wm., farmer, sec. 35; born in
 Cheshire, Berkshire Co., Mass., March 5,
 1815; came to Co. April 6, 1854; mar.
 Emeline Burk, April, 1858; she was born in
 Cheshire, Berkshire Co., Mass., March 8,
 1815; 9 children; Julia A. born June 22,
 1839; Lucy Marian, Dec. 4, 1840; Dan W.,
 July 11, 1842; Harriet A., May 29, 1844;
 Lois Gertrude, Nov. 21, 1847; Mary L., April
 1850; Cora A., Dec.24, 1853; Frank H., July
 11, 1857 [Died Nov. 11, 1859]; Frances H.,
 Aug 24, 1859, [Died Jan. 4, 1862];
Bowers A.P., farmer,
Bowers O.H.P., farmer; sec. 29;
Bowers S.A., farm, sec 29;
Brearley Jno. T., grain & lumber mercht.;
 Meriden; born in Montour Co., PA, June 24,
 1842; came to Co. March 27, 1862; wife was
 Belle A. Whitney, born in Schuyler Co.,
 N.Y., Aug. 31, 1849; mar. Jan.25, 1870; 2
 children, Harvey, June 4, 1871; Mary W.,
 Sept. 11, 1874;
Brown Joseph, Painter, Meriden;
Bruell August, farmer;
Bruell Ferdinand, born in Goubin, Germany,
 Jan. 13, 1824; came to Co. 1869; mar.
 Hannah C. Creed, born in Goubin, Ger,
 Sept.1, 1820; mar; July, 1846; 4 Children,
 August, Dec. 10, 1850; Minnie A., Dec. 17,
 1859; John F., July 13, 1851 [died April 5,
 1867]; Minnie, Sept. 29, 1847 [died Oct. 13,
 1847];
Budach Geo., Farm; sec. 25;
Bunker J.M., farmer; sec. 10;
Burt G., farmer; sec. 15;
Burt Wm., lives with father; sec. 15;

Cady Wm., farmer; sec. 27;
Cane A.B., farmer; sec. 19;
Cannon A.J., farmer; sec. 28;
Cannon N.C., carpenter;
Cary J., farmer,
Cary Thos., farmer; sec. 27; born Co.
 Limerick, Ireland, 1820; came to U.S. May
 20, 1850; this Co. 1852; wife Julia Brazel
 born Limerick Co., Ireland, April 1822; mar.

MERIDEN TOWNSHIP - 1877

Jan. 10, 1841; 7 children; Maggie J. born Dec. 10, 1842; Jessie, March 25, 1844; Mary A., May 20, 1847; Patrick, March 12, 1849; John, Dec. 20, 1850; Johanna, Oct. 2, 1857; Catherine, Oct. 8, 1859;
 Carr A.H., farmer, Sec. 22
 Carter J.O., grain dealer, Meriden
 Caruth M. farmer, sec. 18;
 Case J.A., farmer, sec. 2;
 Casey Nick, laborer, Meriden;
 Chambers J.W., physician, Meriden;
 Cheeney A.
 Clapp Y., farmer, sec. 14;
 Clark Danforth S., farmer, sec. 1; born in Mass. 1840; came to Co. 1862; wife nee Mary Atherton; 3 children, Wilber R., Clarence E. and Arthur;
 Connor Jno., farmer, sec. 15;
 Connor Jos., farmer
 Cook Lyman, farmer, sec. 25; born in Wallingford, New Haven Co. Ct, Nov. 12, 1827; wife nee Sarah Halliday born Allegheny Co., N.Y., Sept. 10, 1829; mar, July 4, 1850; 10 children; Helen E. born May 8, 1851; Emily, March 5, 1853 [died Oct. 19, 1854]; Gertrude D, March 8, 1855; Clara A., May 15, 1857; Carroll E., Aug. 22, 1859; Arthur, Nov. 16, 1861, [died June 29, 1864]; Elmer E., Jan. 22, 1864; Ira D., Jan. 3, 1867; Berton L., Nov. 14, 1869; Guy H., Sept. 15, 1872;
 Cook P.S., farmer, sec. 35; born here in 1852; rents 240 acres of father; mar. Cora A. Houland, 1875; she was born in N.Y.; one child, Alfred E.;
 Cooper James, laborer on H.C. Craver farm; Sec. 22;
 Cooper S, laborer, Meriden;
 Cox Emery, farm; sec. 36
 Craver Abram, farmer; sec. 4; born in Stephenstown, Rensselaer Co., N.Y., April 9, 1838; came here 1849; mar. Letitia A. Dunham, born Woodstock, Windsor Co., VT, July 10, 1845; mar. Jan. 1, 1860; 4 children, Eugene D. born June 1, 1862 [died March 1, 1863]; Clarence Y, Dec. 26, 1863; Wilmer

R., July 3, 1868 [died March 14, 1871]; Leon A., Feb. 15, 1876;
 Craver Henry C., farm; sec. 22;
 Crisler Chas., farm; sec 29;
 Crisler Edward, farm; sec. 32;
 Crisler Franklin, farm; sec. 28;
 Crisler Fred., farmer, sec. 28; born in Steuben Co., N.Y., Feb. 6, 1842; came to this Co. 1850; mar. Emma Cody, Dec. 25, 1865; 5 children, Rose E., Etta B., Ruth, Clarence and Albert.; he owns with his brother, the trotting horse 'Observer'. They bought it when four yrs. Old for \$100. \$15,000 has been refused for him. Record time 2:24 1/2.
 Crisler Hiram, farm; sec. 32;
 Cunningham Jas., farm; Sec. 6;

 Davenport Chas., farmer, sec. 3;
 Davenport A., farmer,
 Davenport S.B., farm; sec. 7
 Davis T.J., farm; sec. 21;
 Decatur Wm., broom-maker, Meriden;
 Doane C., farmer, sec. 36; born in Easthamm Barnstable Co., Mass. Oct. 2, 1806; came here 1834; first wife was Harriet Johnson born in Boston, Mass. mar. Dec. 1831, died May 1834; 2nd wife was Hannah Stilson born in Williamstown, N.Y., June 19, 1811; mar. Nov. 26, 1837; 10 children, Hazen C., born in Mass. April 11, 1834 [first wife], Samuel J., Sept. 22, 1838 [died in army, Feb. 1870; Robert C., March 31, 1840; Harriet, Dec. 28, 1842; James E., Jan. 13, 1845; Caroline A., Nov. 8, 1847; Bernice A., Sept 28, 1848; Mary E., Martha and Maud triplets born March 28, 1852; [Martha died July 28, 1852; Maud died Sept. 1853]
 Doane Robt. C., sec. 36;
 Dolan Henry, laborer;
 Dowling Asa, farmer; sec. 30; born in Niagara Co. N. Y. Nov. 10, 1818; came to Co. July 3, 1847; wife was Sarah Wisner, born Niagara Co., N.Y., Nov. 20, 1825; mar. May 16, 1844; 6 children, Amanda, June 12, 1845; Lorenzo, Jan. 26, 1847; Lafayette, Dec.

MERIDEN TOWNSHIP - 1877

19, 1848; Eugene S., Aug. 14, 1851; Francis M., Sept. 12, 1856; Charles, Aug. 5, 1859;
Dowling Eugene, farm;
Dowling J.C., farm; sec. 35;
Dowling Wm., retired farmer;
Dunham A., farm; sec. 5;
Dunham Jno., farm; sec. 2;
Dunham Jos., farm; sec. 5;
Dumond Lewis W., farmer; sec. 35; born in Wayne, Steuben Co., N.Y., April 11, 1817; came to Michigan, 1854, from there to Meriden Twp. in May, 1854; First wife was Fanny McConnell born Wayne, N.Y., May 15, 1823; married April 7, 1839; died May 28, 1861; second wife was Mrs. Lydia Blowers, born Jan. 13, 1823; married Aug. 19, 1861; 12 children, Geo. McC. Born Dec. 22, 1841; Geo. W., Sept. 5, 1843; Helen Ann, July 15, 1845; Charles W., Oct. 9, 1847; Sarah J., Nov. 23, 1853; died Dec. 20, 1861; Lewis A., April 7, 1856; Frances L., Sept. 9, 1858; Jennie A., May 16, 1861, died Jan. 23, 1862; David C., Nov. 2, 1862; Halsy and Mary, Oct. 22, 1864; Mary died Aug. 1, 1865; Bessie, Nov. 24, 1866, died Jan. 21, 1868;

Eager Thos. farmer; sec. 26;
Eager Geo. C. farm;
Eager Jno., farmer;
Elliott R. E., laborer, Meriden;
Engleskershen Peter, farmer, sec. 17;
Everett J. O., school teacher;

Farnham D.B., lives with father, sec. 15;
Farnham P., farmer; sec. 15;
Franks Chas. T., farmer, sec. 31;
Franks Uriah, farmer, sec. 31; born in Wayne Co., Ohio, March 1, 1816; came to Co., Oct., 1856; first wife was Nancy Stotler, born in PA; second wife was Caroline M. Chambers born in Eng.; married Feb. 10, 1852; six children, two dead; Elizabeth, Francis A., Henry T., Mary and Catharine, by first wife; Chas. T., born in Wayne Co. Ohio; March 10, 1852 by second wife;

Freeland Jno. W., farmer, sec. 31; born in Dearborn Co., Ind., Feb. 8, 1832; came to this Co. 1856; wife was Sarah E. Presher, born in Tioga Co., N.Y., Nov. 14, 1836; married Nov. 16, 1854; 8 children, Ellice E., born Sept. 3, 1855; Herbert E., [deceased] June 8, 1857; Carrie A., Nov. 15, 1862; Marcia M., Nov. 26, 1864; Nora B. [deceased] Oct. 1, 1866; Vie L., Feb. 21, 1870; Lyman E., Oct. 28, 1871; Cora Y., May 11, 1874;
Fuller F.E., farmer Sec. 10;
Fuller Grant E., farmer, sec. 10; born in Belcher, Hampshire Co., Mass., March 2, 1828; came to this Co. in 1861; wife was Cynthia A. Braman, born in Belcher, Aug. 16, 1828; married June 15, 1848; died March 26, 1876; five children, Francis L., May 15, 1849; Frank E., July 23, 1854; Flora E., Feb. 22, 1857, died Feb. 28, 1865; Allie B., Oct. 19, 1859, died Oct. 19, 1860; Emma, March 4, 1864;

Garvey Jno., section boss on railroad;
George A.N., laborer, Meriden;
George T.S., farmer. sec. 30;
Gill Geo., farmer, sec. 2; born in Germany, 1832; came to Co. 1865; married Fredericka Moghle, in 1859; she was born in Germany; five children; George, Louisa, Henry, Lewis and Ada, one adopted daughter Ida
Gillet A.D., farmer, sec. 30;
Gillett Samuel N., farmer, born Granby, Hartford Co., Conn. Sept. 22, 1825; came to Co. Oct. 15, 1833; wife was Eliza Wisner, born Niagara Co., N.Y., Oct. 5, 1834; married Nov. 25, 1849; three children, Adelbert D., Sept. 4, 1850; Marietta A., Nov. 27, 1853; Florence E., Aug. 21, 1858; all born in La Salle County.
Goundry F., shoemaker, Meriden;
Green A.E., farmer, sec. 24;
Green H.B., farmer, sec. 24;
Green W., farmer, sec. 24;
Grey A., farmer, sec. 33;

MERIDEN TOWNSHIP - 1877

Grey G., farmer, sec. 27;
Griffin Asa, farmer & stock raiser, sec. 1;
born in Tioga Co., Penn., 1839; came to Co.
in 1846; married Mary S. Stevens, 1868; she
was born Ohio; one child Violet May;

Haight S. J. Sr., farmer, sec. 6;
Haight S.J. Jr., farmer, sec. 6;
Hapeman W.E. Jr., clerk with father;
Hapeman W.E. Sr., lumber merchant;
Earlville;
Harp Thos., laborer, Meriden;
Harris H., laborer, Meriden;
Harvey H., station agent, C.B. & Q. R.R.
Meriden
Harvey L., blacksmith, Meriden;
Haslett S.N., Rep. to state Legislature;
farmer, sec. 32;
Herron M., laborer on R.R.; Meriden;
Hoffman Herman, farmer, sec. 15; rents 80
acres from father;
Hoge P.M., rents farm; sec. 36;
Hormell Joel, farmer, sec. 18; born in
Warren Co., Ohio, March 1, 1812; came to
Co. in 1865; first wife was Christina Singer
born in Germany; married April 10, 1833;
died Oct. 6, 1864; second wife Mary
Patterson, born in N.Y., May, 1820; married
June 3, 1869; has had 8 children- 3 died,
Elizabeth born Aug. 23, 1835, Ellen
[deceased], Clarissa [deceased]; Matilda,
Mary, Sarah, John Wm., George W;
Hotchkiss A., laborer, Meriden;
Hough A.G., farmer, sec. 5;
Hough George, farmer, sec. 5;
Hough Noah, farmer, sec. 3; born in Weston
Underwood near Derby, Eng., May 18, 1826;
came to U.S., March 14, 1850; wife was
Lavina Rigley born in Yorkshire, England,
Dec. 30, 1836; married, Jan. 1, 1859; 2
children, William, Oct. 12, 1859; Ella E., Jan.
15, 1862;
Howard H., rents farm;

Jacoby M.S., farmer, sec. 21;
Jones D.E., farmer, sec. 10;

Kaminky Gottlieb Sr., farmer, sec. 23;
Kiminky Gottlieb, farmer, sec. 23; born in
Prussia, Germany, Jan. 13, 1845; came to
U.S. July 1, 1858, to Co. same year; wife was
Augusta Grimm born in Prussia, Germany
July 12, 1845; married April 27, 1867; 3
children, Alfred A., April 17, 1868; Oswald
Otto, March, 1869; Louisa, April 10, 1872;
Keeler F.G., farmer, sec. 9;
Keeler J.B. rents farm;
Keeler S.H., farmer, sec. 8;
Keeler S.R., farmer;
Kerns John, laborer;
Kilmer George
King C.C., horse & cattle dealer, Meriden;
Klebsch Gottlieb, farmer, sec. 14; born in
Prussia, Aug. 16, 1826; came to this Co.
1854; wife was Ann Elizabeth Yasch, born in
Prussia, Sept. 7, 1827; married Dec. 1851; 7
children, Ernst, May 13, 1855; Hannah, Feb.
24, 1858; Mary, June 13, 1860; Gustof, Sept.
11, 1862; Henry, June 13, 1864; Mena Dec.
13, 1866; Ann Elizabeth, Aug. 1868;
Kline T., rents farm;
Kuney Smith, farmer, sec. 13; born in Wis.
1859; came to this Co. 1868; married Alice
Boozle in 1874; born in Co. 1856; 2 children
Perpent and Cora;

Lauderbauch Geo., farmer, sec. 20;
Larabee J.W., farmer, sec. 4;
Lehmann Fred, farmer, sec. 14; born in
Prussia, Oct. 24, 1832; came to county, 1860;
married Caroline Fritz, she was born in
Germany; five sons, Fred, John, Albert,
Ernest and Charles;
Lindsay John H., farmer, sec. 8; born in
Howland, Penobscot Co., Me., Sept. 15,
1827; came to Co. 1828; wife was Amelia S.
De Wolf, born in Virgil, Cortland Co., N.Y.,
Dec. 29, 1830; married Nov. 3, 1856; has had
seven children; Edmond D. Oct. 2, 1857, died
Sept. 2, 1858; Wilson, April 19, 1859, died
Jan. 19, 1860; Lucy A., Jan. 3, 1861; John
W., April 21, 1863; Alva D., April 28, 1864
died March 28, 1866; Edmond F. April 29,

MERIDEN TOWNSHIP - 1877

1867, died Sept. 2, 1867; Harry S. Feb. 22, 1874;
 Lowder C.L., farmer;
 Lowder H. Sr., carpenter, Meriden
 Lowder H.W., farmer, sec. 20;
 Luce L.J., farmer;
 Luce J. B., farmer, sec. 15; born in N.Y. 1822; came to this Co. 1858; rents farm, 200 acres of R.S. Hopper, married Esther C. Ives, 1851; she was born Vt; three children Isaac J., Esther C. and Frances A.E.;
 Lynn Jas., farmer sec. 22;

McBride Sam'l, farmer, sec. 19;
 McBride R., farmer, sec. 19;
 McCray T., farmer, sec. 23;
 McGarry Thos., farmer, sec. 25;
 McGraw Thos., farmer, sec. 32; born in Louisiana 1853; came to Co. 1864; married Jennie Kerns, March 7, 1877;
 McKinney J.A., farmer, sec. 14;
 McManus A., farmer, sec. 25;
 Manley J.B., blacksmith, Meriden;
 Meads Arthur D., farmer, sec. 2; born in Mass. in 1853; came to Co. in 1867; married Nora Glover, in 1875; she was born in Co.; one child, Regie, born Aug. 26, 1876;
 Meads H.C., farmer, sec. 1;
 Meinke Fred, farmer, sec. 13;
 Miller Hiram, farmer, sec. 29;
 Morrison Joseph, farmer, sec. 28;

New B., rents farm;
 New J., rents farm;
 Norton H.H., farmer, sec. 4; born in Maine, 1814; came to Co. 1849; married Betsy W. Batchelder, March 31, 1846; she was born in Maine; ten children, Hiram O., Lydia, Ellen, Emaline, John, Ira, Sarah, Isaac, Harrison, Levi; lost one son and one daughter;
 Norton H.O., farmer, sec 3;
 Norton H., farmer, sec. 4;
 Norton J.B., farmer, sec. 3;

Otto Augustus, farmer
 Otto Chas., farmer, sec. 30;

Otto L.F., farmer,
 Perry G.L., farmer;
 Perry W.P., rents farm;
 Plumb Edson, speculator, Earlville;
 Pohlman Frank, farmer;
 Pohlman Fred., farmer, sec. 20;
 Pohlman Henry, farmer;
 Powers Mrs. Mary H., widow, sec. 36; born in Vermont 1810; came to Co. 1855; married Cyrus Powers in 1832; he was born in Vermont, died Oct. 10, 1873; six children, William H, Mary S., Albert C., Darius W., Julia A., Marcus K.; lost four daughters;
 Prentice H.W., farmer, sec. 3; born in Mass., in 1849; came to Co. in 1860;
 Presher Wm. H., farmer, sec. 5;

Riggs Jno., farmer, sec.17;
 Richardson Wm. R., farmer, sec. 12; born in North Adams, Mass., 1836; came to Co. 1853; married Isabel Setchel, 1870; she was born in Co.; two sons, David H. and Willie E.
 Richmond E., laborer, Meriden;
 Richmond E.W., laborer, Meriden;
 Risley Chas., rents farm;
 Risley Lafayette, farmer, sec. 34; born in N.Y. 1824; came to Co, 1856; married R. Weaver in 1848; she was born N.Y.; three children, William, Charles and Anna; lost two Orlando and Katie;
 Risley Wm., farmer;
 Robbins Josiah C., farmer, sec. 23; born in Orange Co., N.Y., March 27, 1822; came to Co. 1852; wife Lousina Parker, born in Bellefonte, Penn., March 13, 1824; married Dec. 10, 1850; died Nov. 25, 1873; three children, Chas. C. Aug. 12, 1853, died April, 1870; Horace P., May 7, 1857; Flora A., May 30, 1861;
 Roberts Irwin, carpenter, Meriden;
 Roehm Chas., farmer, sec. 34;
 Rose Jno., farmer, sec. 6;
 Rose Lewis, farmer;
 Rose Thos., farmer;

MERIDEN TOWNSHIP - 1877

Rudolph Samuel, farmer, sec. 1; born in Baden, Germany, 1836; came to Co. 1864; married Anna M. Baker in 1859; she was born in France; four children, Samuel, Jacob, George and Caroline;

Sanders Phillip, farmer, sec. 28;

Sheffield D., laborer,

Shepardson Henry C., farmer, sec. 26; born in Vermont, 1830; came to Co. 1854; married Betsy A. Barker, 1852; she was born in Washington Co., N.Y.; five children, Allen, George, Diett, Orion, Adolph;

Simpson Jno, rents farm;

Smith Adoniram, farmer, sec. 31;

Smith Allen, farmer, sec. 20;

Smith Barney, farmer, sec. 10;

Smith D. B., farmer, sec. 29;

Smith F.B., laborer;

Smith H.E., farmer,

Smith J. L., farmer, sec. 28;

Smith R., farmer, sec. 18;

Smith Wm., farmer, sec. 24;

Stall G.A., farmer, sec. 11;

Stall H.W., rents farm; sec. 11;

Stone Hugh, Groceries; Meriden

Stouffer C.P., farmer, sec. 23; born in Penn.; came to Co. 1868; rents 120 acres of Mrs. Stouffer and children; married Mrs. Mary A. Lynn, 1868; one child Mary Clark; Mr. S. has two children by former marriage, Althea and Lizzie; Mrs. S. has two children by former marriage, Samuel S. and Willie;

Sweenson Lewis, laborer; Meriden;

Sullivan Jan, laborer on H.O. Norton farm; sec.3;

Templer Chas., laborer; Meriden;

Theurer Jno., farmer, sec. 27; born

Wurtemberg, Germany, June 10, 1826; came to U.S. Nov. 28, 1851; came to Co. 1857; 1st wife Mary Dealsnider, born in Prussia, Germany, married March 10, 1855; died Oct. 13, 1858; 2nd wife Barbara Bishop, born in Baden, Germany, March 17, 1836; married Dec. 27, 1859; 11 children Mary Jan 30,

1856, by first wife; John C., Dec. 26, 1857; Wm. F. died Nov. 28, 1867; Lewis P., July 24, 1861; Catherina B., April 4, 1863; Anna M., May 5, 1865; Charles F., Feb. 15, 1867; Wm. L., Jan. 10, 1869; Henrietta M., Aug. 16, 1870; Adeline M., April 16, 1872; Julia B., Dec.16, 1874;

Thompson D.H. rents farm; Earlville;

Tillson L.B., farmer and stock raiser, sec. 12; born in Mass. 1829; came to Co. in 1854; married Sarah Wylie in 1859; born in Maine; have three children, Fred, Ned, and Mabel; **Tripp Eben**, farmer, sec. 15; born in Maine 1812; came to Co. in 1854; married Mary Hutchins who was born in Maine; had two children by first wife, and 2 by second; lost 1 **Tripp D.E.**, farmer, sec 15;

Van Horn J.C. farmer; Meriden;

Walterbury Frank J., laborer; Meriden;

Weidner Wm., farmer, sec. 25

Welch Michael, laborer; Meriden;

Weygandt Solomon, farmer, sec. 16;

White D.G., farmer, sec. 7; born in Rhode Island, Dec. 31, 1821; came to Co. 1855; first wife was Mrs. Margaret Soper; second wife was Caroline Tewksbury; married Jan. 13, 1859; died in 1863; third wife Margaret Johnson, born in Essex Co., N.Y., Feb. 12, 1833; married Jan. 5, 1864; had ten children, two dead and eight living;

White E., farmer, sec. 29;

White James, farmer, sec.29;

Whitney Byron L., farmer, sec. 21;

Whitney C. B., Veterinary Surgeon; Meriden

Wicks Ed., farmer, sec. 18;

Wicks E.C., farmer, sec. 18;

Wicks Ebenezer R., farmer, sec. 18; born in Rensselaer Co., N.Y., Oct. 25, 1823; came to Co. Sept., 1848; wife was Mary A. Craver born in Stephenstown, Rensselaer Co. N.Y., June 14, 1828; married Feb. 21, 1847; have 9 children, Matilda F., Feb. 1, 1849; Elebert C., Jan. 17, 1852; Madona A., June 21, 1854; Edgar N., May 11, 1856; Alonzo J., July 12,

MERIDEN TOWNSHIP - 1877

1858; Minnie V., Nov. 28, 1862; Elenor E.
Sept. 12, 1864; Marilla Ellen, Sept. 1, 1866;
Freeman U., Sept. 5, 1870;
Williams H., farmer, sec. 3;
Williams Orson, farmer, sec. 3;
Wirt D.L., farmer, sec. 5;
Woldsworth W., farmer, sec. Sec. 16:

Meriden Business Directory

Brearley Jno. T. Grain and Lumber Dealer

[source Past & Present of La Salle County,
1877]

**Official**

The township settled very slowly. It was not populous enough to warrant a civil organization until 1856. The officers elected each year since then.

1856- Supervisor, O.H.P. Bowers; Clerk, D.G. White; Assessor, John Rose; Collector, Henry C. Shepardson; Highway Commissioners, Henry Allen and Ralph Potter.

1857- Supervisor, O.H.P. Bowers; Clerk and Assessor, D.G. White; Collector, John R. Miller, Highway Commissioners, Corren Doane and S.H. Keeler.

Population

The western fever had for ten years or more keep the population from increasing. The census returns showed 1870 – 1069 – 151 foreign born in 1880 it was 991 inhabitants.

The first Political election for president was held in the township in 1852.

[source 1886 History of La Salle County]

POTAWATOMI INDIANS

There was an Indian trail from Shabbona's and Waubonsee's villages near Paw Paw in Lee County over to Four Mile Grove then to Meriden and Mendota. The Potawatomi Indians, who were much friendlier to the settlers than those near LaSalle and Ottawa. Camped at the grove until 1840.

Chief Shabbona would come to the farms to buy meat, the farmer usually threw in some vegetables. They tried to teach the Indians to grow their own but that didn't seem to fit their culture. Shabbona would load his meat and produce onto a sledge made of poles, tie it to his pony's tail and ride off to his camp.

Once a farmer wagered with Shabbona that his horse could beat his pony in a race. The race was on whichever mount lost was to be the winners prize. Shabbona won. The farmer didn't really want to give up his good horse, so it was agreed that Shabbona prize would be some of his wife's dishes.

[source La Salle County Lore]

**ROUTE 34**

In 1920s the railroad was supplemented by US 34, which was laid through the center of the township. They started by digging a deep well in Meriden for the workers mules. If the creek ran low they could also use it for the cement. A mule shed was put up. All the sand and gravel came in by rail. There was another shed put up for the cement. There were 40 – 50 men with the construction company. They graded the road with slip scoops, graders and mule power. They put the culverts in one year and poured the cement the next. The Mendota to Meriden road was opened in 1926 it continued on to Earlville in 1929. [source La Salle County Lore]

REFERENCE ONLY

MERIDEN



Town & Country Publishing Co., Inc.



P.O. BOX 689 • 1012 MONROE ST
LA PORTE, IN 46350 • PHONE 219/362-8508

ORANGE COUNTY CALIFORNIA
10 GENEALOGICAL SOCIETY

